

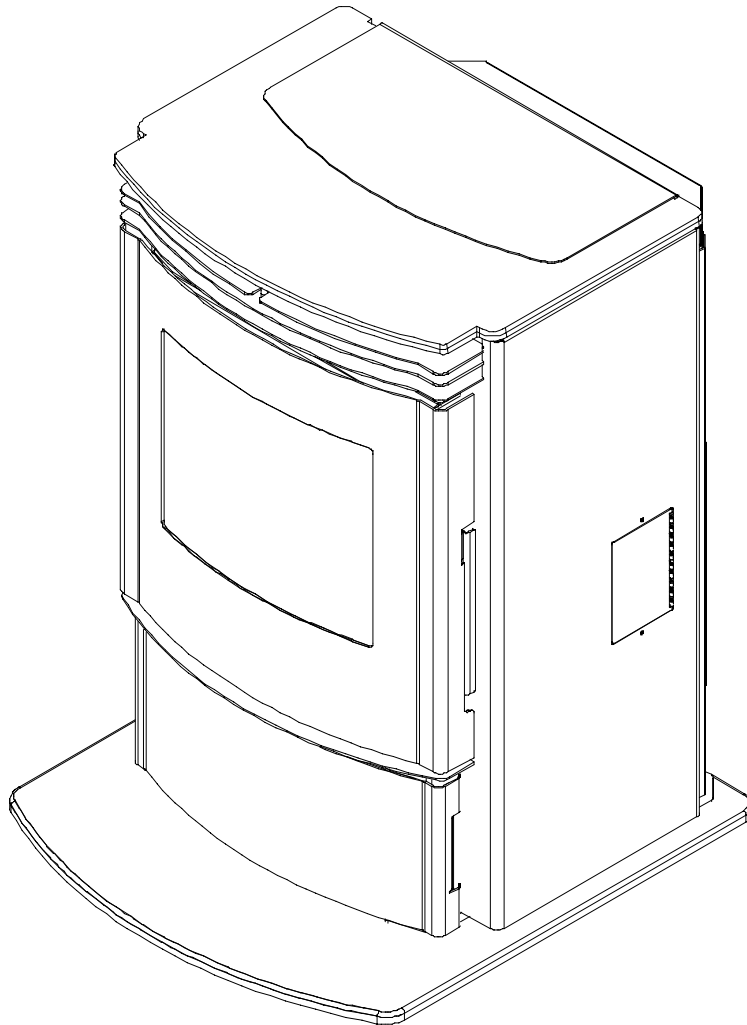

**PELLET STOVE**  
***EF-V EVOLUTION***  
**OWNERS TECHNICAL MANUAL**



**Warnock Hersey**



**SHERWOOD INDUSTRIES LTD.**

6782 OLDFIELD RD  
VICTORIA, BRITISH COLUMBIA V8M-2A3

---

# ENVIROFIRE INSTALLATION MANUAL

---

## TABLE OF CONTENTS

<b>1) <u>INTRODUCTION</u></b>	<b>PAGE</b>
Pellet Quality .....	3
Important Safety Data.....	4
Warnings and Recommendations.....	5
Automatic Safety Features .....	5
Deciding Where To Locating Your Pellet Appliance .....	6
Fireplace Dimensions .....	6
Removing Your New Stove From It's Pallet.....	7
Pedestal Installation .....	7
<b>4) <u>INSTALLATION</u></b>	
Vent Termination Requirements .....	8
Clearances to Combustibles.....	9
Mobile Home Installation .....	10
Outside Fresh Air Connections.....	10
Horizontal Exhaust through the Wall .....	11-12
Inside Vertical Pipe Installation.....	13
Hearth Mount Installation.....	14
Exterior Mounted Exhaust Blower .....	15-18
<b>2) <u>OPERATION</u></b>	
How to Start Your Pellet Appliance.....	19
Turning Your Pellet Appliance Off .....	19
Slider/Damper.....	20
<b>3) <u>SPECIFICATIONS / MAINTENANCE</u></b>	
Areas for Routine Maintenance .....	21-22
Electrical Component Functions .....	23-25
<b>5) <u>SERVICE</u></b>	
Troubleshooting.....	26-29
Wiring Diagram.....	30
Parts List .....	31
Exploded views.....	32-33
Warranty .....	34

---

## PELLET QUALITY IS IMPORTANT, PLEASE READ THE FOLLOWING PAGE

---

Your pellet stove has been designed to burn wood pellets only. Since there are many manufacturers of wood pellets it is important to select pellets that are free of dirt or any impurities. The Pellet Fuel Industries (P.F.I.) has established standards for wood pellet manufactures. We recommend the use of pellets that meet or exceed these standards. Ask your dealer for a recommended pellet type.

**THE PERFORMANCE OF YOUR PELLET STOVE IS GREATLY AFFECTED BY THE TYPE AND QUALITY OF WOOD PELLETS BEING BURNED. AS THE HEAT OUTPUT OF VARIOUS QUALITY WOOD PELLETS DIFFER, SO WILL THE PERFORMANCE AND HEAT OUTPUT OF THE PELLET STOVE.**

Since Sherwood Industries Ltd. has no control over the quality of pellets that you use, we assume no liability caused by the quality of wood pellets used.

### P.F.I. PELLET STANDARDS:

Fines .....	1% maximum through a 1/8" screen
Bulk Density .....	40 lbs. per cubic foot minimum
Size .....	1/4" to 3/8" diameter 1 – 1.5" long maximum
Ash Content .....	1% maximum
Moisture Content.....	8% maximum
Heat Content.....	approximately 8200 Btu per lb. minimum

Check the burn-pot liner periodically to ensure that the holes are not blocked with clinkers, (clinkers are silica in the fuel that will form a hard mass during the burning process). If they are blocked, remove the liner (when the unit is cold) and clean the clinkers out. The liner should be cleaned or scraped once every 2-3 days depending on wood pellet quality. Clean the holes in the lines with a small pointed object.

Store pellets at least 36" (1 m) away from the pellet stove.

---

## IMPORTANT SAFETY DATA

---

To prevent the possibility of a fire, ensure that the appliance is properly installed by adhering to the installation instructions. An ENVIROFIRE dealer will be happy to assist you in obtaining information with regards to your local building codes and installation restrictions.

The stove's exhaust system works with negative combustion chamber pressure and a slightly positive chimney pressure, it is very important to ensure that the exhaust system be sealed and airtight.

This unit is designed to burn pelletized wood fuel only. Do not use any other type of fuel, this will void any warranties stated in this manual.

### **THE USE OF CORDWOOD IS PROHIBITED BY LAW.**

Do not burn with insufficient combustion air. A periodic check is recommended to ensure proper combustion air is admitted to the combustion chamber. Setting the proper combustion air is achieved by adjusting the slide damper located on the left side of the stove.

It is advisable to clean the exhaust vent bi-annually or every two tons of pellets.

The grounded electrical cord should be connected to a standard 115 volts, 60-hertz electrical outlet. Be careful that the electrical cord is not trapped under the appliance and that it is clear of any hot surfaces or sharp edges. This unit's maximum power requirement is 470 watts (3.91amps) for the *EF-V EVOLUTION*.

Minor soot or creosote may accumulate when the stove is operated under incorrect conditions such as an extremely rich burn (black tipped, lazy orange flames).

When installing the stove in a mobile home, it must be electrically grounded to the steel chassis of the home and bolted to the floor. Make sure that the structural integrity of the home is maintained.

Be sure to maintain the structural integrity of home when passing a vent through walls, ceilings, or roofs.

The ash pan must be locked securely for proper and safe operation of the pellet stove.

If you have any questions with regards to your stove or the above-mentioned information, please feel free to contact your local dealer for further clarification and comments.

Since Sherwood Industries Ltd. has no control over the installation of your stove, we grant no warranty implied or stated for the installation or maintenance of your stove, therefore, Sherwood Industries Ltd. assumes no responsibility for any consequential damage.

**SAVE THIS INSTRUCTION MANUAL FOR FUTURE REFERENCE**

---

## WARNINGS AND RECOMMENDATIONS

---

- A. Do not abuse the glass by striking or slamming the door shut.
- B. Do not attempt to operate the stove with broken glass.
- C. Do not attempt to open the door and clean the glass while the unit is in operation. To clean the glass, use a soft cotton cloth and mild window cleaner, gas or wood stove glass cleaner or take a damp paper towel and dip into the fly ash, this is a very mild abrasive and will not damage the glass.
- D. Do not use abrasive cleaners to clean the surface or any part of the stove.
- E. It is recommended that the unit be secured into its position in order to avoid any displacement.
- F. Never use gasoline, gasoline-type lantern fuel, kerosene, or similar liquids to start the fire. Keep all such liquids well away from the pellet stove while it is in use.
- G. Disposed ashes should be placed in a metal container with a tight fitting lid. The closed container of ashes should be on a non-combustible floor on the ground, well away from all combustible materials pending final disposal. The ashes should be retained in the closed container until all cinders have thoroughly cooled before disposing of them.
- H. Make sure the ash pan is closed tightly during the operation of the stove.
- I. **KEEP ASH PAN FREE OF RAW FUEL. DO NOT PLACE UNBURNED OR NEW PELLET FUEL IN ASH PAN.** A fire in the ash pan could be the result.
- J. Fresh air intake is strongly recommended. Failure to install Intake air may result in the unit smoking during power failures as well as improper combustion.

**NOTE:** Fresh air is mandatory on all units installed in “Mobile Homes” as well as “Air Tight” homes.

---

## AUTOMATIC SAFETY FEATURES OF YOUR PELLET STOVE

---

- A. The stove will shut off when the fire goes out and the exhaust temperature drops below 120°F (49°C).
- B. The stove has a high temperature safety switch. If the temperature on the hopper reaches 200°F (93°C) the auger will automatically stop, and the stove will shut down when the exhaust temperature cools. If this happens call your local dealer to reset the 200°F (93°C) high limit switch. **ALSO FIND THE REASONS WHY THE UNIT OVERHEATED.**
- C. If the power goes out, the unit will stop running. When the power comes back on, the stove will not restart unless the exhaust temperature is still above 120°F (49 °C).

---

## DECIDING WHERE TO LOCATE YOUR PELLET APPLIANCE

---

1. Check clearances to combustibles.
2. Do not obtain combustion air from an attic, garage or any unventilated space. Combustion air may be obtained from a ventilated crawlspace.
3. Do not install the stove in a bedroom.
4. You can vent the stove through an exterior wall behind the unit or connect it to an existing masonry or metal chimney (must be lined if the chimney is over 6" in diameter, or over 28 sq. inches cross sectional area). An interior vent can be used with approved pipe passing through the ceiling and roof.
5. Locate the stove in a large and open room that is centrally located in the house. This will optimize heat circulation.
6. The power cord is 8 feet (2.43 m) long and may require a grounded extension cord to reach the nearest electrical outlet.

---

## FIREPLACE DIMENSIONS

---

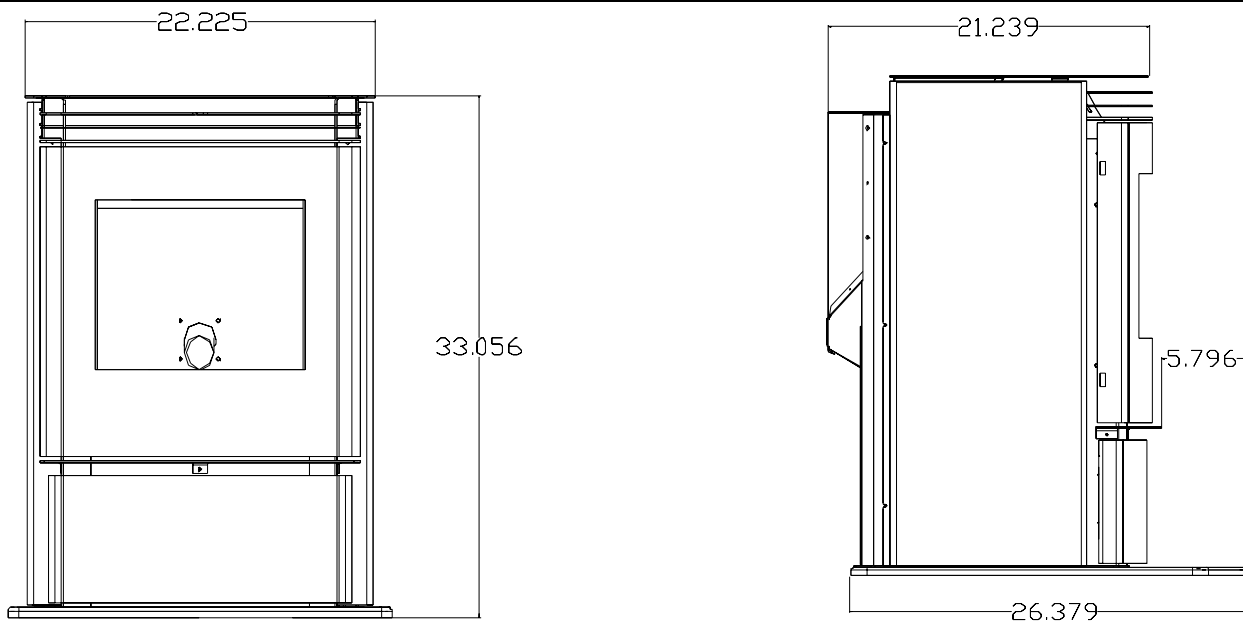

### **FRONT VIEW** **UNIT DIMENSIONS**

HEIGHT: 33.056 (83.96 CM)

WIDTH: 22.225 (56.45 CM)

DEPTH: 21.239 (53.94 CM)

### **HEARTH PAD:**

WIDTH: 24.360 (61.87 CM)

DEPTH: 27.864 (70.77 CM)

### **SIDE VIEW**

### **TOP VIEW**

---

## REMOVING YOUR NEW STOVE FROM THE PALLET

---

To remove your new stove from its pallet, open the left and right side panels. There are two wood screws that are holding the bottom of the stove to the pallet. Remove the screws. Close the side panels.

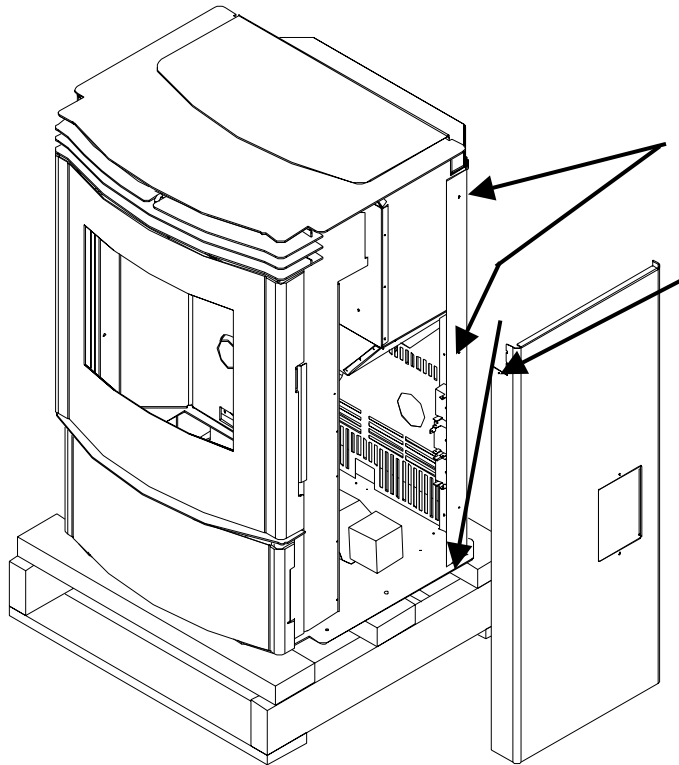

To remove the right and left hand cabinet sides there are three T-20 Torx screws on the back of the panel, loosen these screws only.

Remove the one screw located on the front of the cabinet side located behind the top louvers.

Remove the two wood screws (one on either side of the unit) to remove the unit from the pallet.

---

## HEARTH PAD PEDESTAL INSTALLATION

---

Carefully place the back of the pellet appliance on the pallet and install the hearth pad. Align the holes in the hearth pad and the unit and install the four screws provided.

Place the unit on its back and install the hearth pad using the four screws provided

This unit can be installed on a combustible floor due to the built in pedestal hearth pad, for example linoleum, hardwood flooring. If this unit is to install onto a carpeted surface a hearth pad must be used for stability.

This unit is supplied with 4 leveling legs for uneven surfaces. Adjust these leveling legs until unit is level.

LEVELING LEGS  
X 4

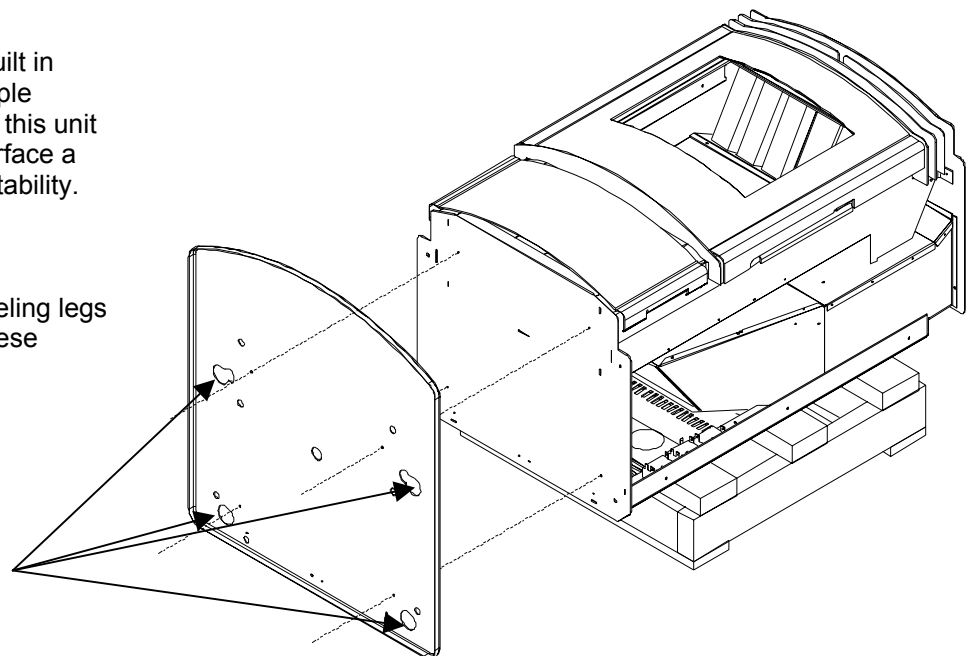

# VENT TERMINATION REQUIREMENTS

1. Do not terminate the vent in any enclosed or semi-enclosed areas such as a carport, garage, attic, crawlspace, narrow walkway, closely fenced area, under a sundeck or porch, or any location that can build up a concentration of fumes such as stairwells, covered breezeway, etc.
2. Vent surfaces can become hot enough to cause burns if touched by children. Non-combustible shielding or guards may be required.
3. Termination must exhaust above the inlet elevation. It is recommended that at least five feet of vertical pipe be installed outside when the appliance is vented directly through a wall to create some natural draft to prevent the possibility of smoke or odor during appliance shut down or power failure. To keep exhaust from causing a nuisance or hazard from exposing people or shrubs to high temperatures. In any case, the safest and preferred venting method is to extend the vent through the roof vertically.
4. Vent terminal cannot be:
  - less than 4 feet (1.2 m) below
  - less than 4 feet (1.2 m) horizontally from, and
  - less than 1 foot (305 mm) aboveDoors, window openings, or gravity/ventilation air inlet into building:
5. Distance from bottom termination and grade –12" (305 mm) minimum.(including exterior exhaust blower) This is conditional upon the plants and nature of grade surface. The exhaust gases are hot enough to ignite grass, plants and shrubs located in the vicinity of termination. The grade surface must not be lawn. Distance from bottom of termination and public walkways is 7 feet (2.1 m) minimum.
6. Distance to combustible materials is 2 feet (610 mm). This includes adjacent buildings, fences, protruding parts of the structure, roof overhang, plants, shrubs, etc.
7. If the unit is incorrectly vented or the air to fuel mixture is out of balance, a slight discoloration of the exterior of the house might occur. Since these factors are beyond Sherwood Industries LTD's. control, we grant no guarantee against such incidents.

## IT IS RECOMMENDED THAT AN AUTHORIZED DEALER/INSTALLER INSTALL YOUR PELLET STOVE

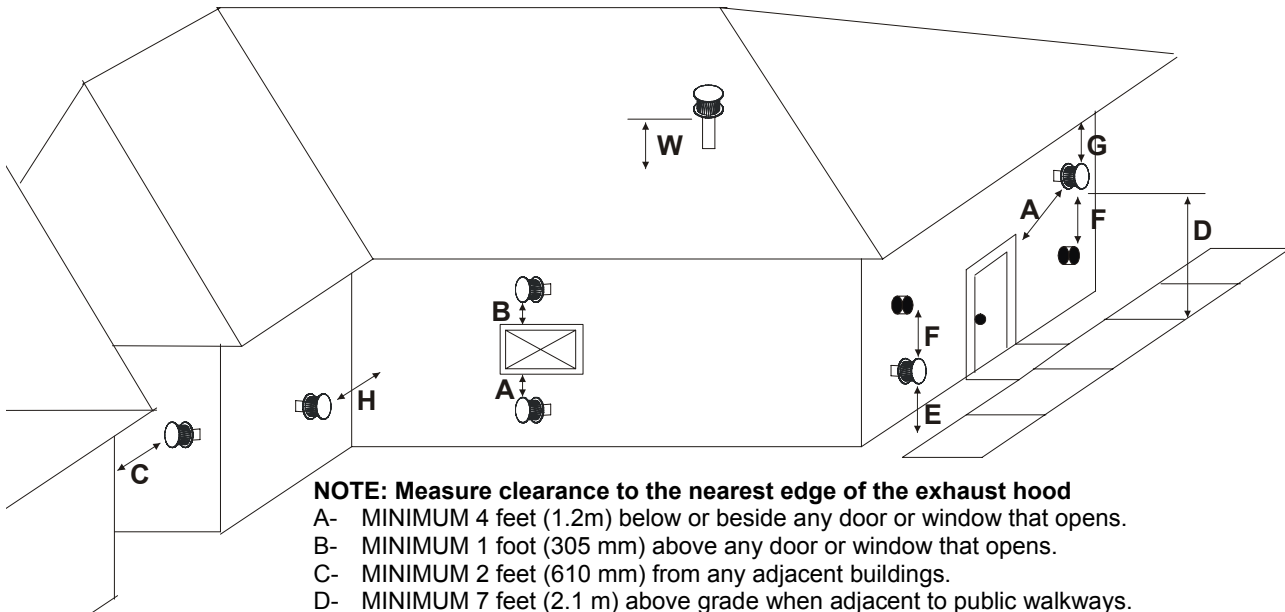

**NOTE: Measure clearance to the nearest edge of the exhaust hood**

A- MINIMUM 4 feet (1.2m) below or beside any door or window that opens.

B- MINIMUM 1 foot (305 mm) above any door or window that opens.

C- MINIMUM 2 feet (610 mm) from any adjacent buildings.

D- MINIMUM 7 feet (2.1 m) above grade when adjacent to public walkways.

(NOTE) Vent may not terminate in a covered walkway or breezeway.

E- MINIMUM 2 feet (610 mm) above plants, grass or other combustible materials.

F- MINIMUM 3 feet (915 mm) from any forced air intake of other appliances.

G- MINIMUM 2 feet (610 mm) below any eave or roof overhangs.

H- MINIMUM 1 foot (305 mm) clearance to a combustible wall.

W- MINIMUM 2 feet (610 mm) above the roof.



## CLEARANCES TO COMBUSTIBLES

This unit can be installed on a combustible floor due to the built in pedestal hearth pad, for example linoleum, hardwood flooring. If this unit is to install onto a carpeted surface a hearth pad must be used for stability.

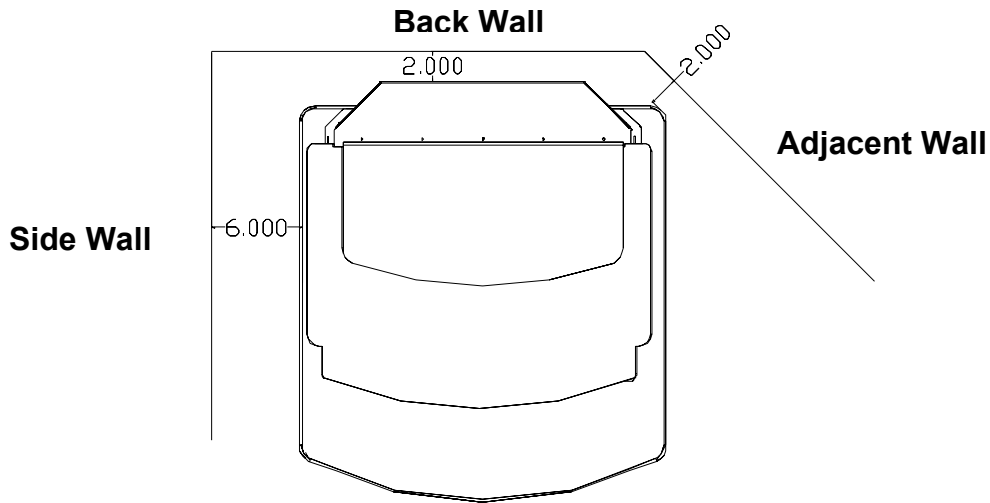

<b>SIDE WALL TO UNIT</b>	6 INCHES (900 MM)
<b>BACK WALL TO UNIT</b>	2 INCHES ( 50 MM)
<b>ADJACENT WALL</b>	2 INCHES (50 MM)

## ALCOVE CLEARANCES

This unit may be installed in an Alcove. Maintain these clearances to combustibles.

<b>ALCOVE WIDTH</b>	36 INCHES (900 MM)
<b>ALCOVE HEIGHT</b>	48 INCHES (1200 MM)
<b>ALCOVE DEPTH</b>	48 INCHES (1200 MM)

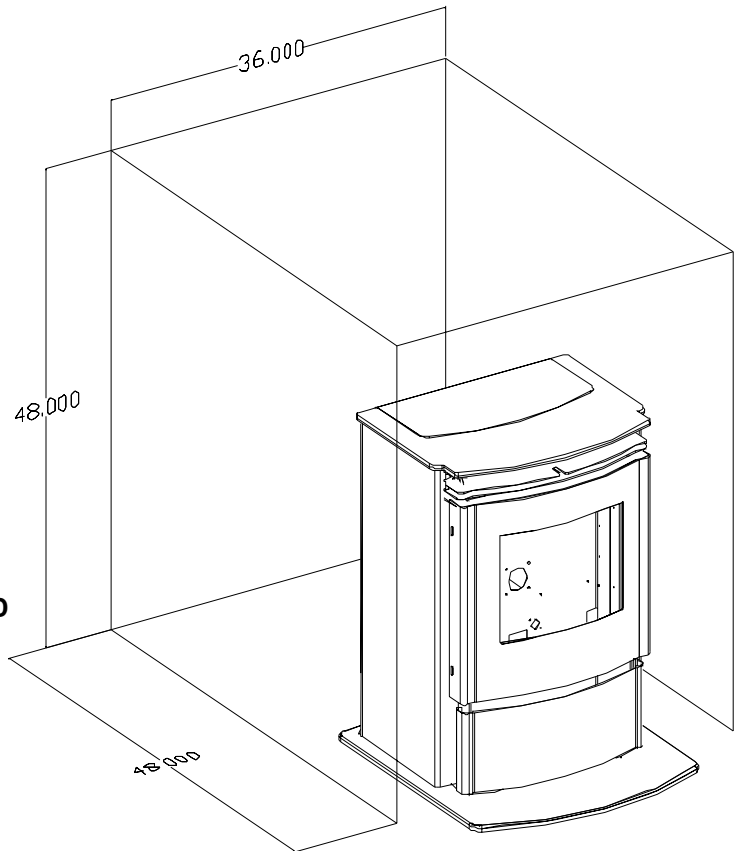

**INSTALL VENT AT CLEARANCES SPECIFIED BY THE VENTING MANUFACTURE.**

---

## EXHAUST AND FRESH AIR INTAKE DIMENSIONS

---

### EXTERNAL MOUNTED EXHAUST BLOWER.

#### (A)

Base to center of flue 8.36 inches (21.34 CM)  
Side to center of flue 8.16 inches (20.72 CM)

### INTERIOR MOUNTED EXHAUST BLOWER.

#### (B)

Base to center of flue 10.71 inches (27.20 CM)  
Side to center of flue 10.62 inches (26.97 CM)

### FRESH AIR INTAKE.

Base to center of intake 8.47 inches (21.51 CM)  
Side to center of intake 7.97 inches (20.54 CM)

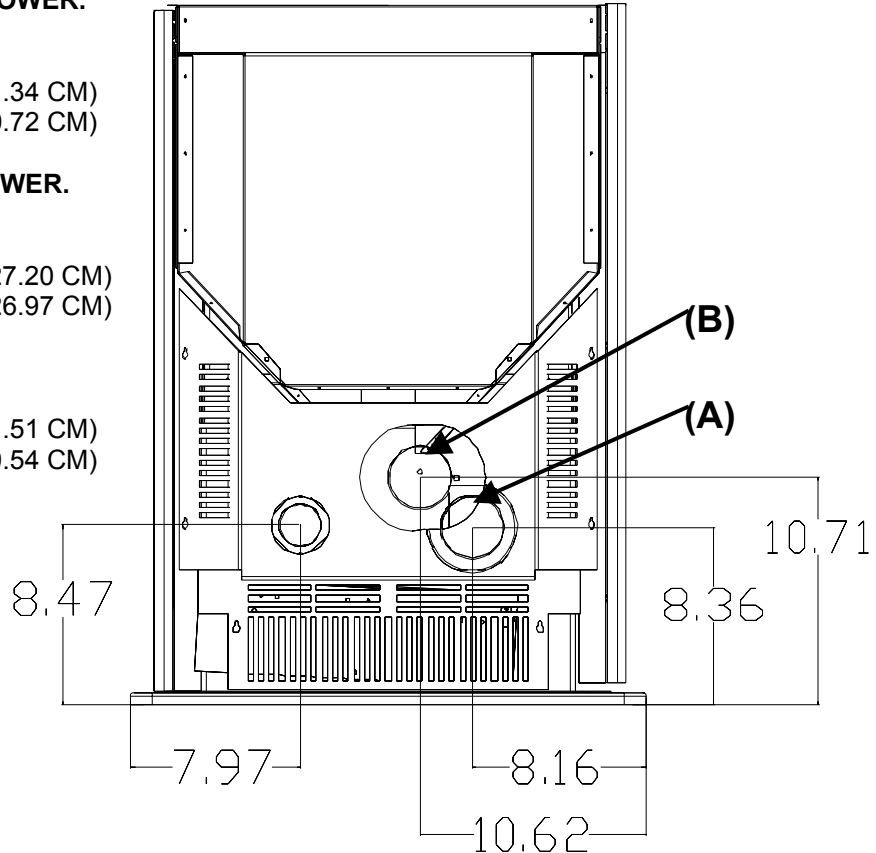

---

## MOBILE HOME INSTALLATION

---

- Secure the heater to the floor using the two holes in the pedestal. Do not disturb the structural integrity of the home.
- Ensure the unit is electrically grounded to the chassis of your home (permanently).
- Do not install in a room people sleep in.
- Outside fresh air is mandatory.

---

## OUTSIDE FRESH AIR CONNECTIONS

---

**Outside fresh air is mandatory when installing this unit in airtight homes and mobile homes.** When connecting to an outside fresh air source, do not use plastic, combustible pipe. Only 2" ID (inside diameter) steel, aluminum or copper pipe should be used. It is recommended, when you are installing a fresh air system, to keep the number of bends in the pipe to a minimum.

---

# INSTALLATION

---

## HORIZONTAL THROUGH WALL INSTALLATION

The **ENVIROFIRE EF V EVOLUTION** can be vented through the wall using two different methods.

### STRAIGHT THROUGH THE WALL.

1. Choose a location for your stove that meets the requirements stated in this manual and allows installation with the least amount of interference to house framing, plumbing, wiring, etc.
2. Place the appliance 15" (37.5 cm) away from the wall. If the stove is to be set on a hearth pad, set the unit on it.
3. Locate the center of the exhaust pipe on the stove. Extend that line to the wall. Once you have located the center point on the wall, use a hole saw to cut a 10" (254 mm) diameter hole for a 3" (76 mm) vent pipe or an 11" (279 mm) hole for a 4" (101 mm) vent pipe.
4. Install the wall thimble as per the instructions written on the thimble.
5. Install a length of 3" (76 mm) or 4" (101 mm) vent pipe into the wall thimble. The pipe should install easily into the thimble.
6. Install the fresh air intake.
7. Connect the exhaust vent pipe to the exhaust pipe on the stove. Seal all connections with high temperature silicone
8. Push the stove straight back, leaving a minimum of 2" (5 cm) clearance from the back of the stove to the wall. Seal the vent pipe to the thimble with high temperature silicone.
9. The pipe must extend at least 12"(30 cm) away from the building. If necessary, bring another length of pipe (PL type) to the outside of the home to connect to the first section. Do not forget to place high temperature silicone around the pipe that passes through the thimble.
10. Install a vertical pipe, or if all requirements for direct venting are met, install vent termination. The stainless steel cap termination manufactured by the vent manufacturer is recommended. However, when the vent terminates several feet above ground level and there are no trees, plants, etc. within several feet, a 45-degree elbow with rodent screen can be used as a termination. The elbow must be turned down to prevent rain from entering.

### **NOTE:**

Some horizontal through wall installations may require a "T" and a 3 to 5 foot of vertical pipe outside the building to help natural draft in the unit.

This may be required if a proper burn cannot be maintained, after the stove has been tested and the airflow set.

This is due to the backpressure in the exhaust caused by air-flow around the structure.

---

## STRAIGHT THROUGH WALL INSTALLATION

---

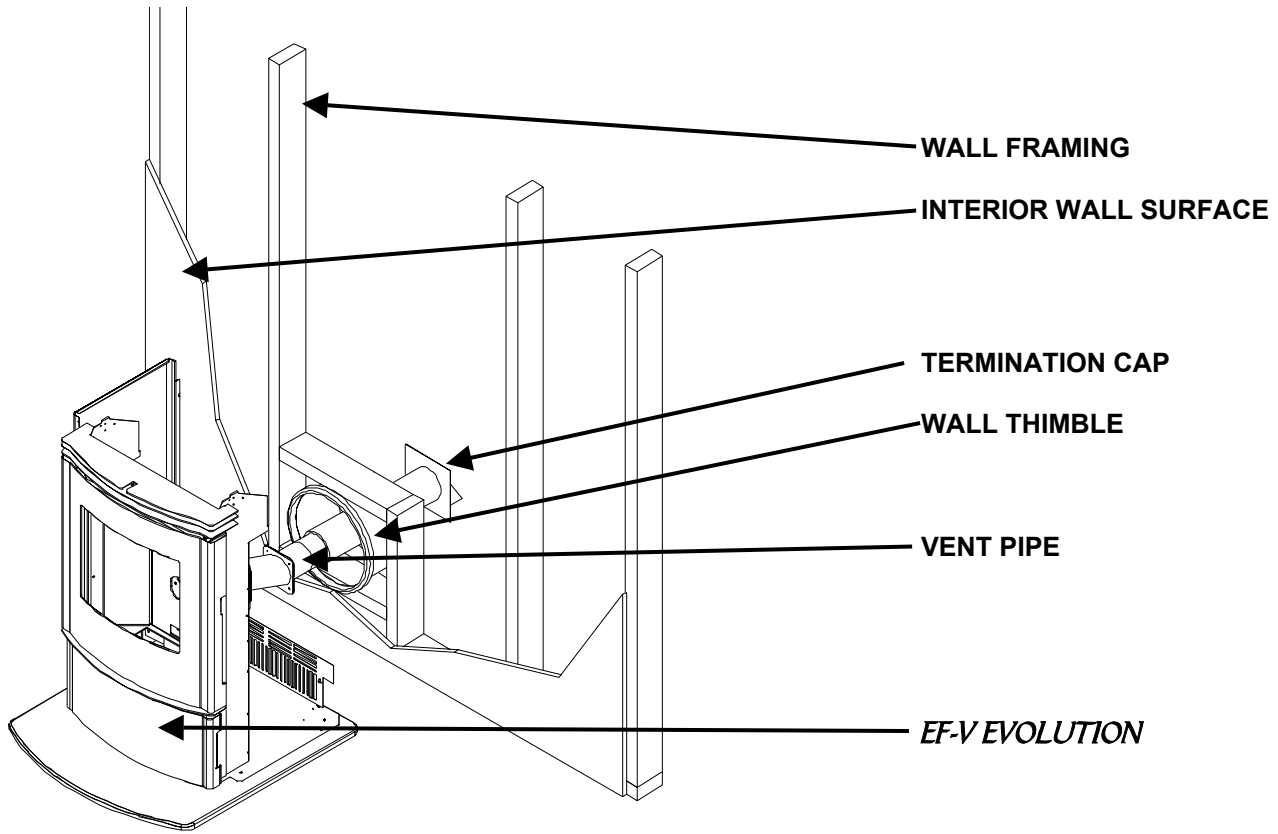

---

## THROUGH WALL WITH VERTICAL RISE (recommended)

---

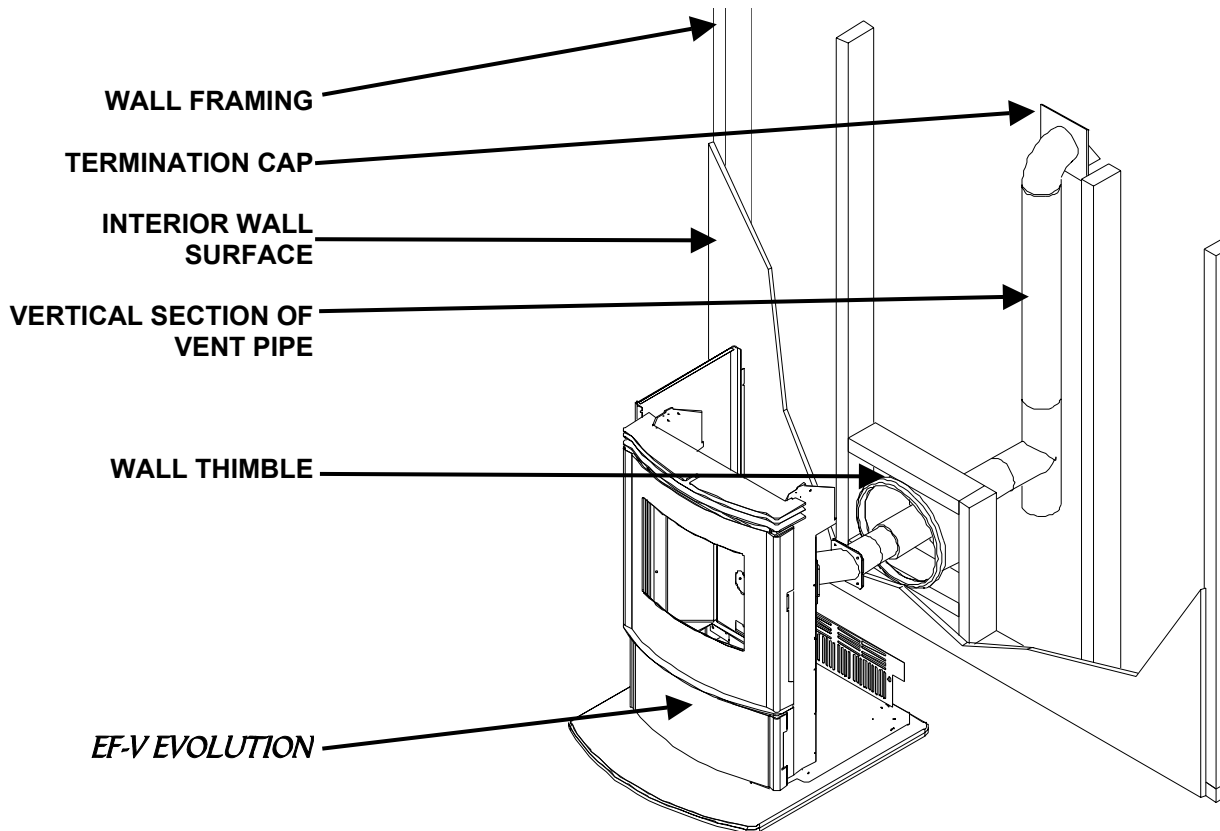

# VERTICAL INSTALLATION

1. Choose a stove location that is ideal. See the section Deciding Where to Locate Your Pellet Appliance.
2. Place the unit on the hearth pad (if installed on a carpeted surface.) and space the unit in a manner so when the pellet vent is installed vertically, it will be 3" (76 mm) away from a combustible wall.
3. Locate the center of the fresh air intake pipe on the unit. Match that center with the same point on the wall and cut a hole about 2 1/8 (53.9 mm) in diameter.
4. Install the fresh air intake pipe.
5. Install the tee with clean out.
6. Install the pellet vent upward from there. When you reach the ceiling make sure that the vent goes through the ceiling fire stop. Maintain a 3" (76 mm) distance to combustibles and keep attic insulation away from the pipe.
7. Finally, extend the pellet vent to go through the roof flashing.
8. Ensure that the rain cap is approximately 36" (900 mm) above the roof.
9. The same methods apply for vertical installation outside. Install wall thimble and pipe supports.

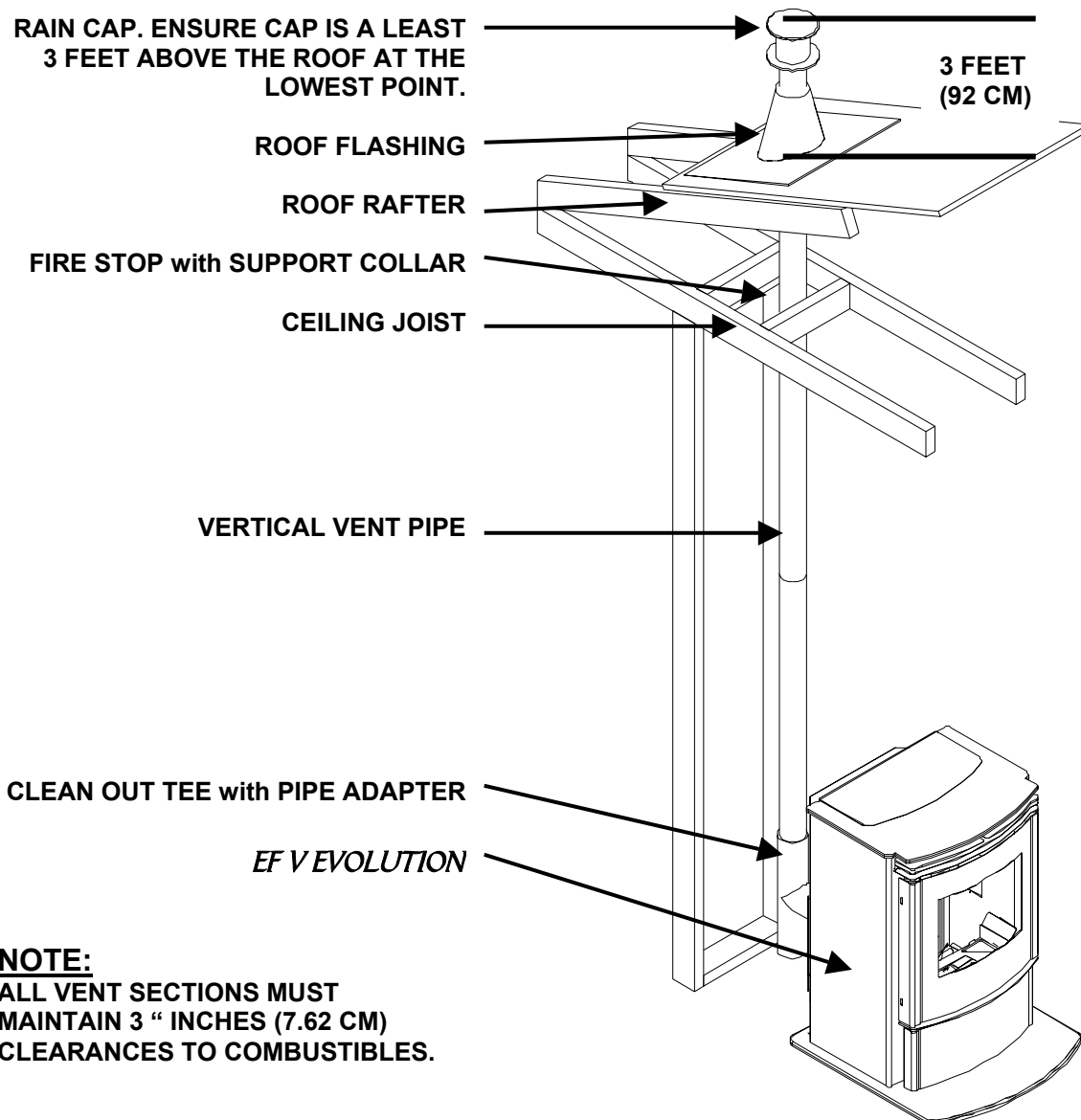

---

## HEARTH MOUNT INSTALLATION

---

1. Lock fireplace damper in the open position.
2. Install positive flue connector at the fireplace dampers.
3. Connect a Tee or a 90° degree elbow to the exhaust pipe.
4. Install flexible stainless steel liner or listed pellet vent to the top of the chimney.

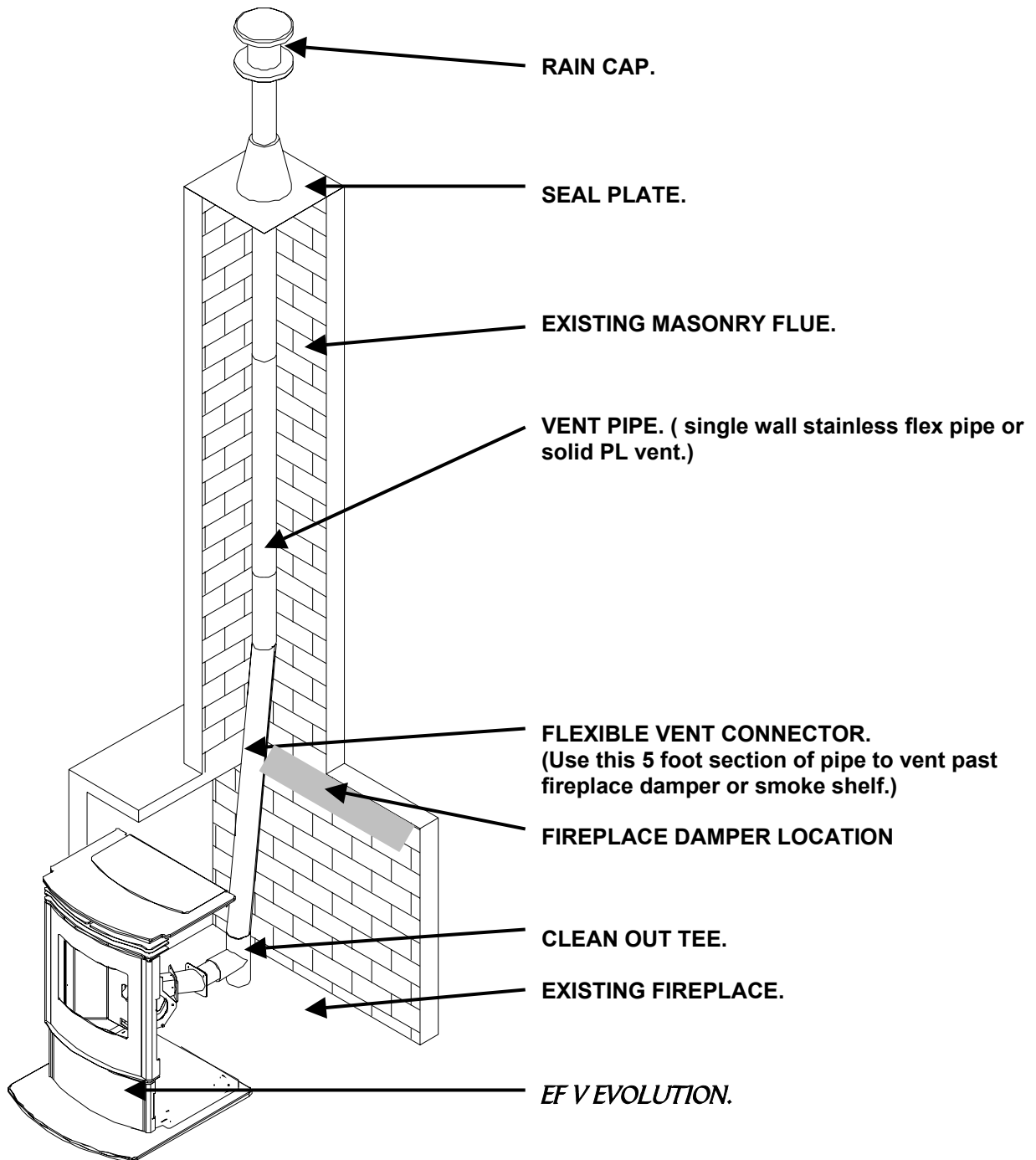

# EXTERIOR MOUNTED EXHAUST BLOWER

The *EF V EVOLUTION* can be equipped with an externally mounted exhaust blower.

This optional kit would include all components necessary to install the exhaust blower on any vertical wall surface.

Choose a location for your stove that meets the requirements stated in this manual and allows installation with the least amount of interference to house framing, plumbing, wiring, etc.

Included in the exterior mounted exhaust blower kit are:

- 1---Exhaust blower housing.
- 1---60° degree pipe to stove adapter.

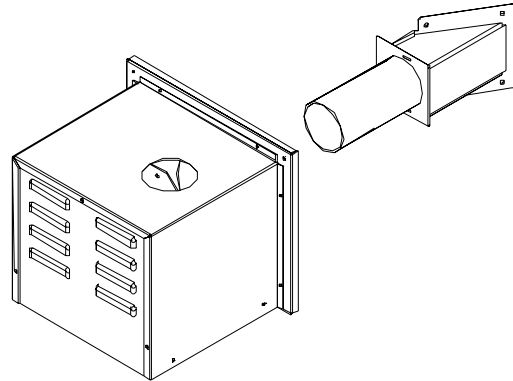

1. Remove the left hand cabinet side by removing (1) one screw between the top louvers. Loosen the three screws on the back of the cabinet side and remove panel.
2. Loosen the four screws that hold the top back grill in place. Lift the back grill off the screws and remove **NOTE:** Remove the knock out to the lower right of the oval hole. This will be the new chimney location.
3. Remove the two small sections of exhaust pipe from the exhaust blower.
4. Discard the middle section of exhaust pipe
5. Re install the exhaust pipe marked # 1 to exhaust blower and remove the exhaust blower from the unit by undoing the (5) five bolts the secure the blower to the housing.
6. Install the 60° deg pipe to stove adapter to the exhaust channel in place of the exhaust blower.

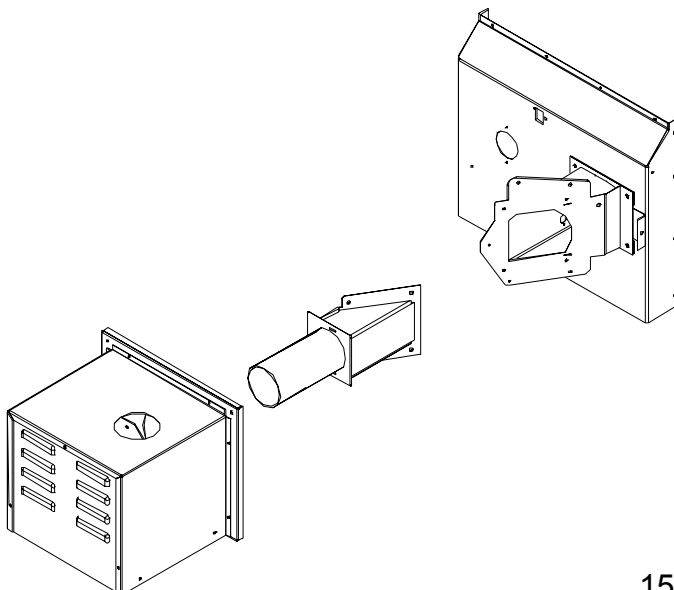
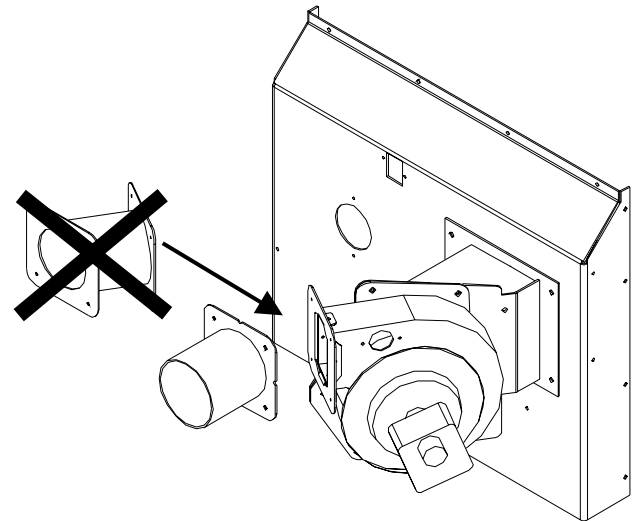

**60 ° DEGREE PIPE TO STOVE ADAPTER  
INSTALLED TO EXHAUST CHANNEL.**

7. Remove the front and bottom sections of the EXTERIOR EXHAUST BLOWER HOUSING and install the

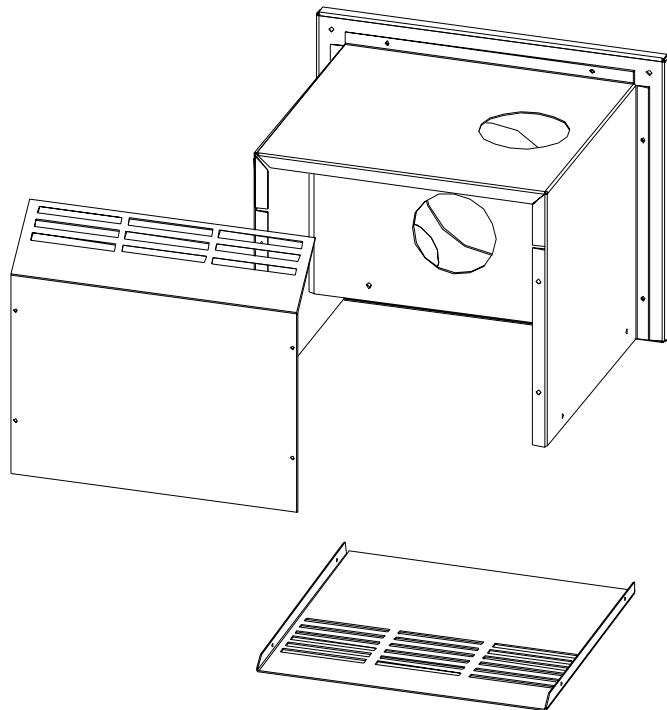

exhaust blower ensuring that the gasket material is not damaged and is properly positioned.

8. Re install the top and bottom sections of the exhaust blower housing and place a bead of high temperature silicone around the exhaust pipe where it exits the exhaust blower housing to create a watertight seal.

**HIGH  
TEMPERATURE  
SILICONE**

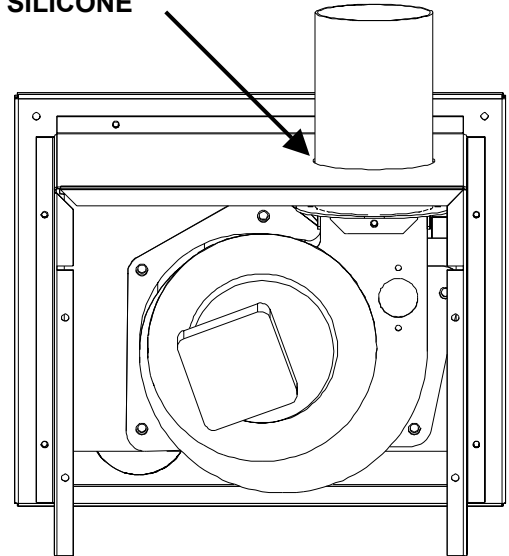

Replace the back grill of the stove and ensure the four screws are tightened.

Follow the procedures for through wall installations. Place the unit in the desired location. Cut hole in the wall at the desired location.

Apply normal venting practices when installing the vent pipe. Start by installing a pipe adapter, then a short section of pipe or an adjustable section through a wall thimble to maintain clearances to combustibles.

**COMPLETED  
EXHAUST BLOWER**

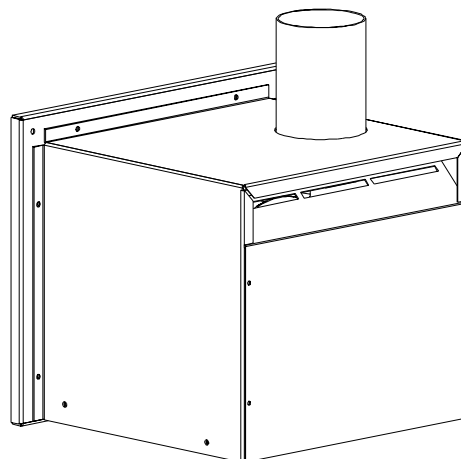



**TYPICAL THROUGH WALL OUTSIDE TERMINATION INSTALLATION.**

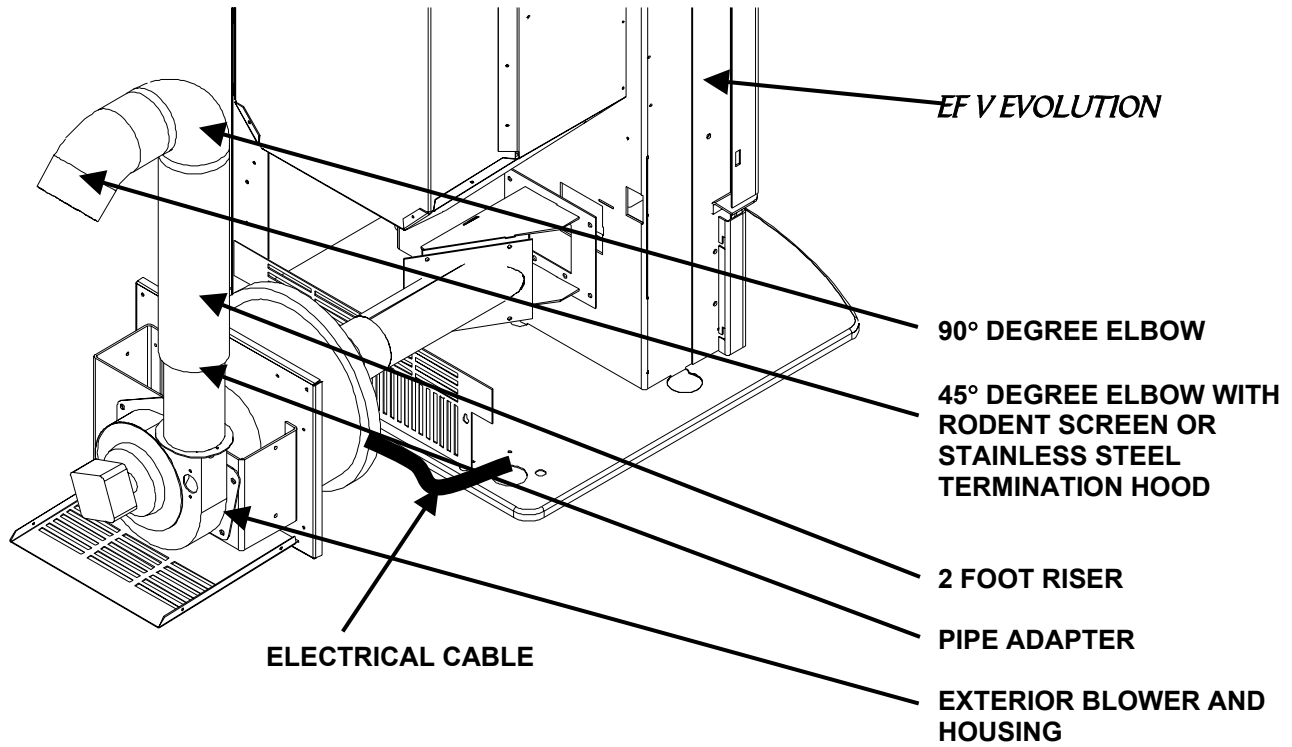

**NOTE:**

Ensure that all vent connections be installed by placing a small bead of high temperature silicone at each chimney connection.

Also ensure that all vertical vent sections are proper supported and the all clearances to combustibles are maintained in accordance with the vent manufacturer's specifications.

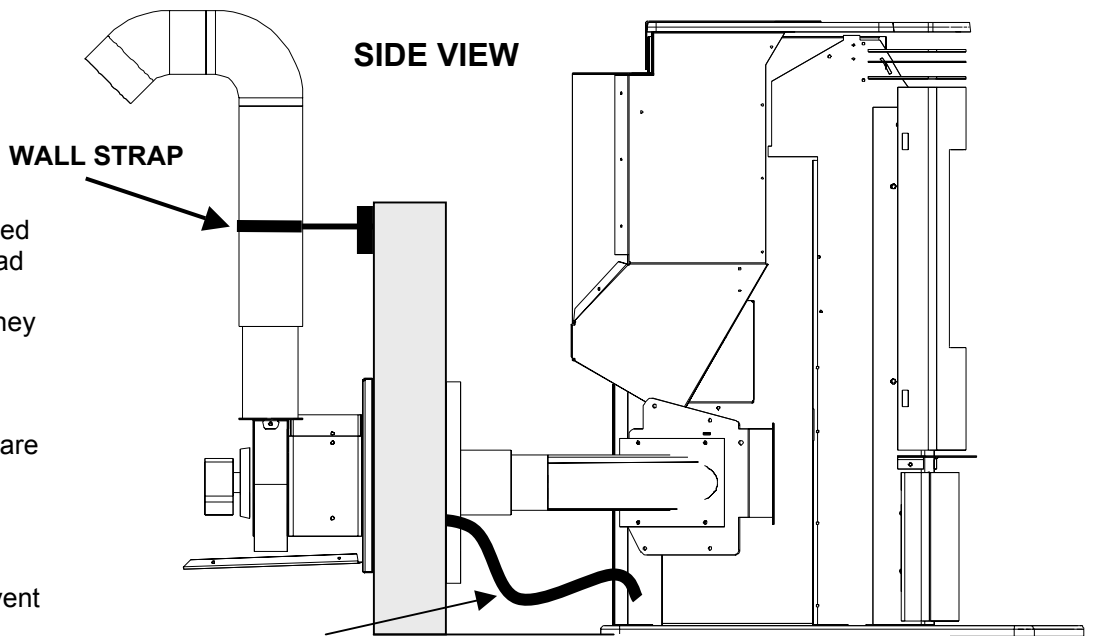

**TO SUPPLY POWER TO THE EXHAUST BLOWER:**

Install an amour coated electrical cable from the exhaust blower housing, through the wall thimble and attach to the pre drilled hole in the left hand rear hopper pillar, and hook up to wires from the wiring harness for exhaust blower  
All electrical connections must be in accordance to local code requirements.

---

# THROUGH WALL VERTICAL INSTALLATION

---

Follow the previous pages for through wall installations. Ensure that vent pipe is properly secured to wall using wall straps. Maintain clearances to combustibles on vent pipe as well as unit.

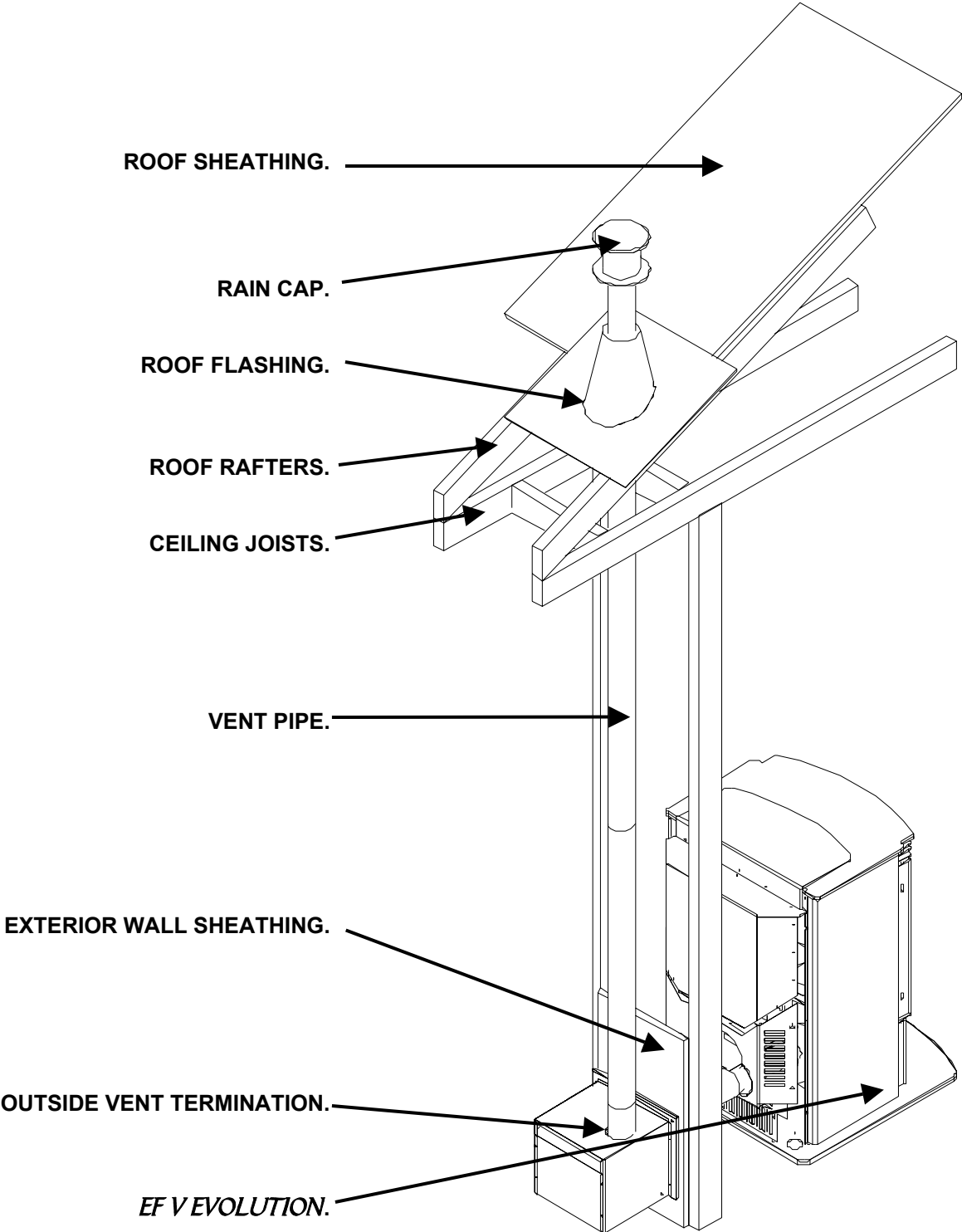

---

## HOW TO START AND OPERATE YOUR PELLET APPLIANCE

---

1. Check and fill hopper with pellets.
2. Make sure unit is plugged into a working outlet.
3. Switch the power “ON” by pushing the start up switch once only.
4. Turn knob “B” to the 12 o’clock position. (**Lower grade pellets may need a higher setting on the feed rate**). **NOTE:** unit will take longer to light if the hopper has been completely emptied.
5. Wait until the fire is established, then turn knob “B” to the desired heat output. (The stove may not be able to burn in the BLUE ZONE if poor quality wood pellets are being used.)
6. If the stove should shut off after 15 minutes and there is still a fire in the firebox – press the start up switch once more. If the fire went out, return to step number 2 and re-light the stove.

Convection  
Blower Speed  
Control  
**KNOB A**

Auger Light

Start-up  
Switch

Dial-A-Fire  
Heat Output  
Knob  
**KNOB B**

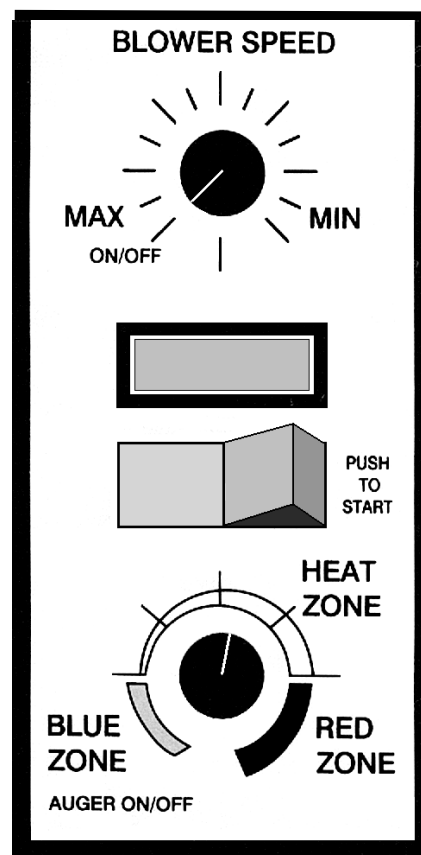

**KNOB “A”:** Fan Controller.

By adjusting the knob you will vary the rate of airflow into the room by varying the speed of the convection blower. When you first start the stove it should be placed in the “OFF” position in order to heat the unit as quickly as possible. Once the room has come up to temperature the control may be set to a comfortable level.

The flashing green **“Auger Light”** corresponds to the timing of the auger turning.

**KNOB “B”:** Dial a Fire Heat Output Knob. This knob controls the amount of heat output. The dial has a scale with the **blue zone** representing the coolest setting of the stove, and the **red zone** representing the hottest setting. The scale on knob “B” represents a range, not exact at times or fuel quantities. Wood pellets of differing quality may effect the performance of the stove. If the stove has trouble operating at either end of its range, turn the heat output knob back slightly.

---

## TURNING YOUR PELLET STOVE OFF

---

To turn your stove off, simply turn the HEAT OUTPUT knob (knob “B”) counter-clockwise until the knob clicks to the “OFF” position. This will stop the feed of pellets. The blowers will continue to run and cool the stove. When cool enough, the stove will shut down.

---

## SLIDER/DAMPER INSTALLATION INSTRUCTIONS

---

This is used to regulate the airflow through the pellet stove.

A Qualified Service Technician or Installer should set the Slider Damper.

The Slider Damper has been pre set at the factory. However, during installation this slider damper might require further adjustment depending on type of installation or fuel quality.

The slider damper is located behind the left side panel. To open the left side panel, undo the one screw located in the upper front corner of the cabinet side between the louvers, also loosen three screws down the back of the side panel.

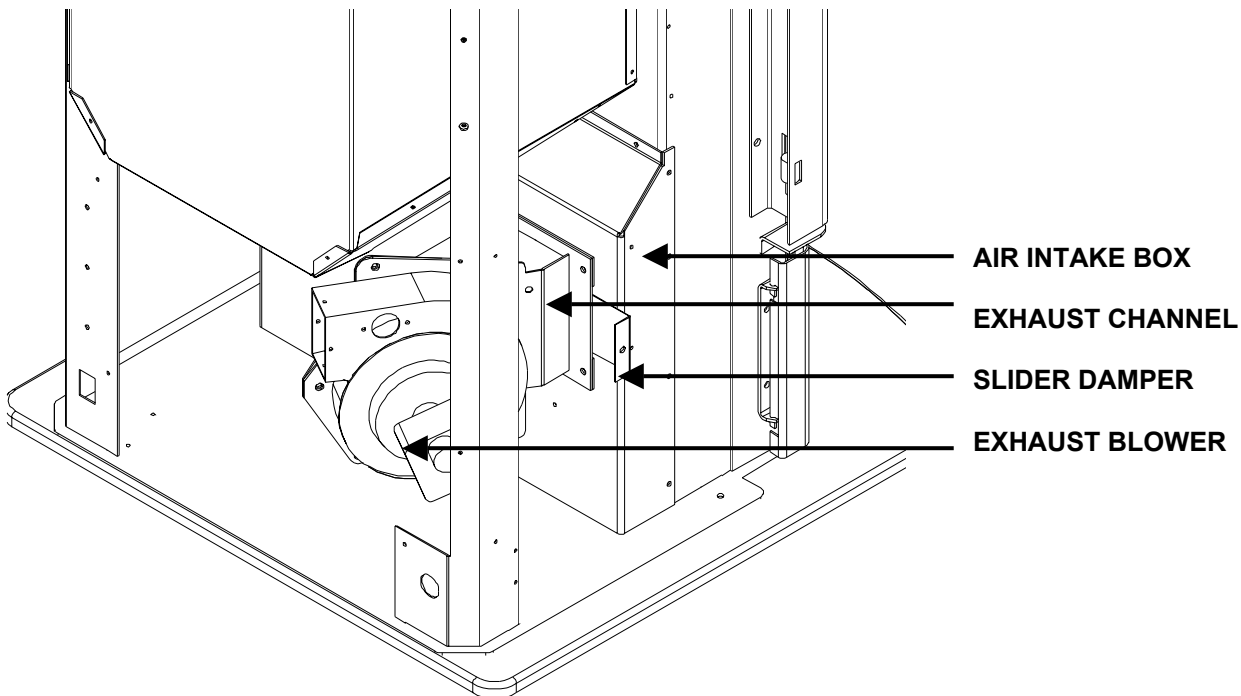

The combustion exhaust blower is a variable speed blower controlled by the heat output knob,(Dial a Fire). This blower will decrease the vacuum pressure inside the stove and as the heat output knob is turned up. The vacuum pressure inside the firebox will increase as the combustion exhaust blower increases in speed.

If the fire should happen to go out and the Dial A Fire has been set on the lowest setting, the Slider Damper should be pushed in slightly decreasing the air in the firebox.

If after long periods of burning the fire builds up and over flows the burn pot or there is a build up of clinkers This would be a sign that the pellet quality is poor and the slider damper must be pulled out to compensate.

Pulling the slider damper out gives the fire more air.

The easiest way to make sure that an efficient flame is achieved is to see the characteristics of the fire.

- A tall and lazy flame with dark orange tips requires more air – Open slider / damper up.
- A short and brisk flame, like a blowtorch, has too much air – Close slider / damper down.
- If the flame is in the middle of these two characteristics with a bright yellow/orange, active flame then the air is set for proper operation.

### **SPECIAL NOTES:**

Pellet quality is a major factor in how the Pellet stove will operate. If the Pellets have a high moisture content or ash content the fire will be less efficient and has a higher possibility of the fire building up and creating clinkers. (hard ash build-up)

---

## AREAS FOR ROUTINE INSPECTION

---

The following should be inspected periodically to ensure that the appliance is operating at its optimum and giving you excellent heat value:

### 2 3 DAYS/WEEKLY

Burn Pot and Liner  
Ash Pan  
Inside Firebox  
Door Glass  
Heat exchanger tubes  
Ash pan and Door gaskets  
Door Latch

### SEASON or 2 TONS OF FUEL

Exhaust Vent  
Fresh air Intake Tube  
Blower Mechanisms  
Heat exchanger tubes  
Latch Mechanism of ash pan  
Behind firebox liners  
All Hinges  
Post Season Clean-up

**TOOLS REQUIRED TO CLEAN UNIT:**..Torx T-20 Screwdriver, 5/16” wrench or socket, Brush, Soft Cloth, Vacuum with fine filter bag

### **ASH PAN AND DOOR GASKETS**

After excessive use the gasketing may come loose. To repair this, glue the gasketing on using high-temperature fiberglass gasket glue available from your local dealer. This is important to maintain an airtight assembly. **DO NOT PLACE UNBURNED OR RAW PELLET FUEL IN ASH PAN.**

### **BURNER POT AND LINER**

This is the ‘pot’ where the pellets are burned. Every two to three days (when the unit is cold), remove the burn-pot liner from the stove. Using a metal scrapper remove material that has accumulated or is clogging the liner’s holes. Then dispose of the scrapped ashes from the liner and from inside the burn-pot. Place the burn-pot back into the stove, making sure that the pipes are properly inserted into the burn pot. Place the liner back into the burn-pot, making sure that the ignitor hole in the liner is aligned with the ignitor tube. Pushing the liner up against the ignitor tube. To remove the burn pot and burn pot liner. Open the door using the door handle provided located on the left-hand side of the stove, swing the door open. Lift the liner from the burn pot, lift the burn pot from the firebox by gently lifting the front of the burn pot up first then sliding the assembly from the air intake tube and the igniter cartridge.

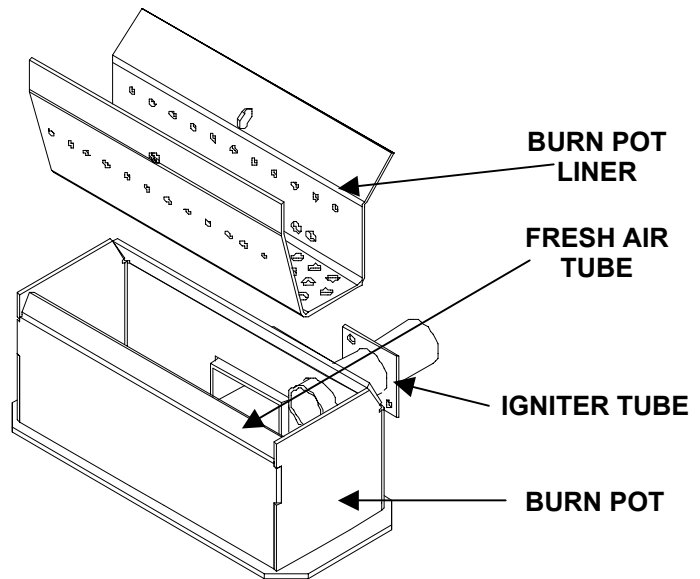

### **FREESTANDING ASH PAN:**

This part is located under the burner, in the pedestal and has a latching mechanism to secure it. To remove the ash pan, open the cover from the right hand side, unlock the latch on the pedestal cover and then pull the pan out. Dump the ashes into a metal container stored away from combustibles. Monitor the ash level every week. **Remember that different pellet fuels will have different ash contents.** Ash content is a good indication of fuel efficiency and quality. Refer to “Warnings and Recommendations” for disposal of ashes.

## DOOR GLASS

### **(It is recommended that your dealer replace the glass if broken.)**

The door glass is made of high temperature PYRO CERAMIC. The center panel is 14" x 14" inches (35.5cm x 35.5 cm). To replace the glass, unscrew and remove the four glass retainers. Remove the glass and any broken pieces. High temperature fiberglass tape should be used around the glass. Replace the glass by screw the glass retainers back to the frame.

## FRESH AIR INTAKE

Inspect periodically to be sure that it is not clogged with any foreign materials.

## EXHAUST PASSAGES

### **Removal of the firebox backing for bi-annual cleaning**

- Open the door by lifting the handle, Remove the burn pot and burn pot liner.
- Lubricate all screws with penetrating oil.
- Remove the four screws that hold the Brick liner and side panels in place. Remove Brick liner
- With the tip of a flat screwdriver, gently lift up the side panels, and remove the side panels.
- Pull the center panel out.
- Vacuum thoroughly.

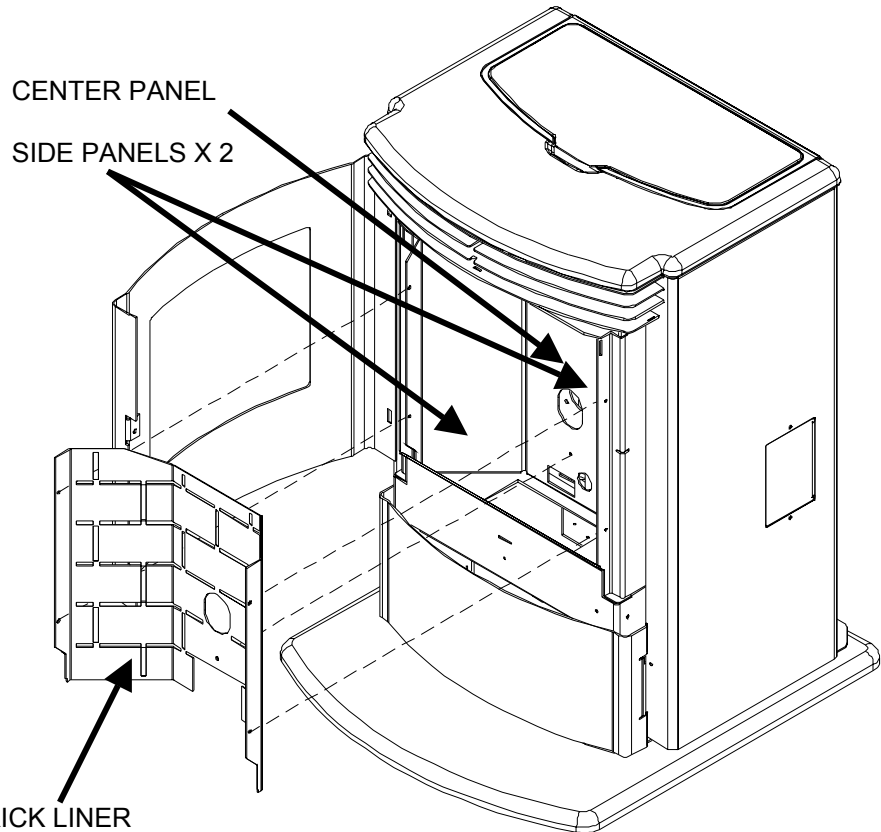

### **Installation of firebox backing:**

- Insert center panel.
- Place the two side panels back into the firebox and Brick liner, reinstall the two screws on each side.
- Replace the glass door and secure.
- Clean thoroughly.

## EXHAUST VENT

This vent should be cleaned every year or after two tons of pellets. We recommend contacting your dealer for professional cleaning. To clean the vent pipe, tap lightly on the pipe to dislodge any loose ash. Open the bottom of the "T" to dump the ash, then vacuum as much of the ash out of the vent pipe as possible.

## HEAT EXCHANGER TUBES

A handle is located under the unit top, in the center of the stove just above the door. This handle is to be pulled up and down a few times (**ONLY WHEN THE UNIT IS COLD**) in order to clean away any fly ash that may have collected on the heat exchanger tubes. As different types of pellets produce different amounts of ash, cleaning of the tubes should be done on a regular basis to enable the unit to run efficiently.

## POST SEASON CLEAN-UP

Once you are finished using the pellet appliance for the season, unplug the stove for added electrical protection. It is very important that the stove be cleaned and serviced as stated above.

---

## ELECTRICAL COMPONENT AND FUNCTIONS

---

Some parts have been removed for clarity.

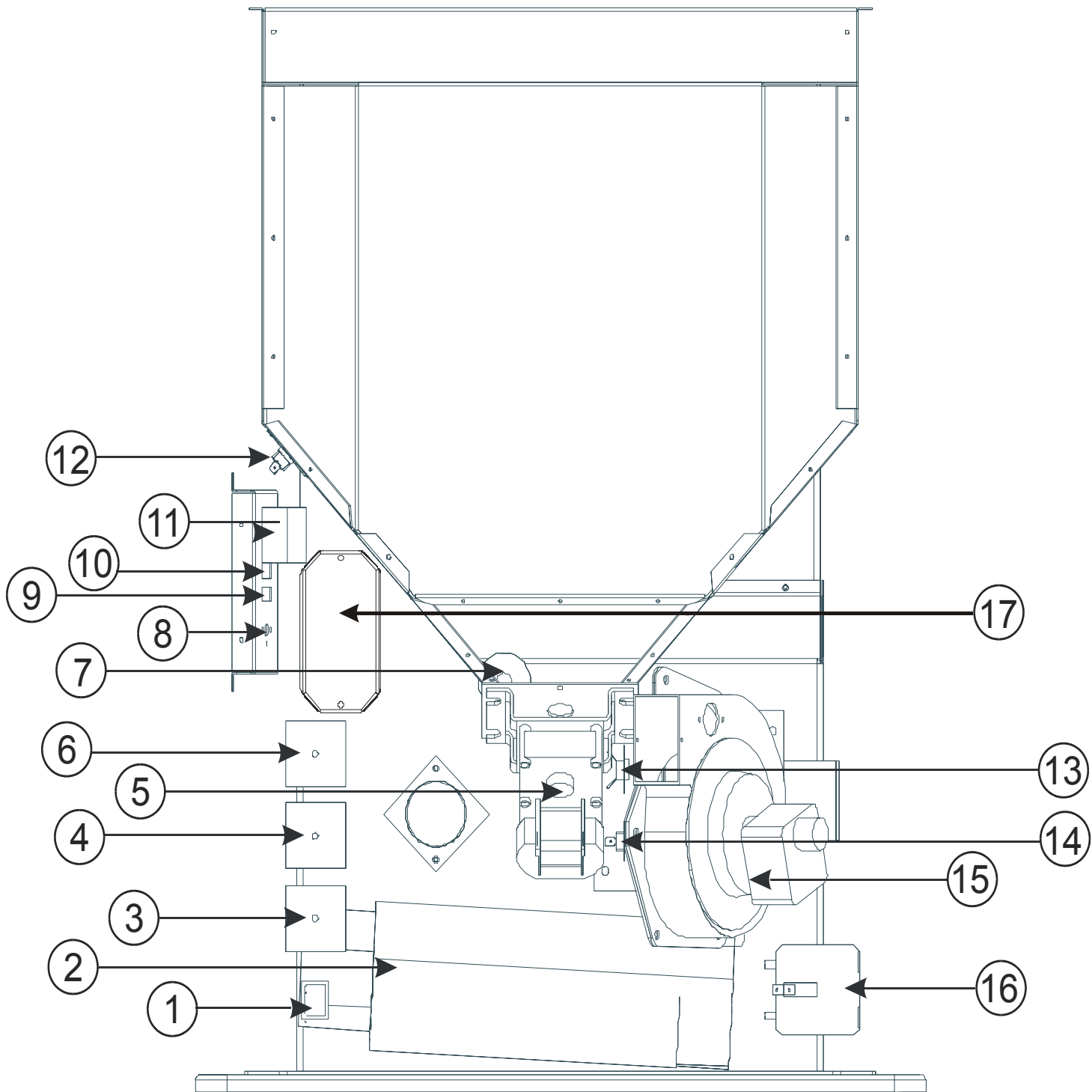

**The following is a list of electrical components and their functions on the ENVIROFIRE EF-V EVOLUTION pellet stove.**

**1 POWER CORD OUTLET.**

Main power supply to the unit supplied at this location.

**2 CONVECTION BLOWER.**

This blower fan, (mounted in the center bottom of the unit) draws room air from the back of the stove and passes the air through the heat exchanger tubes and back into the room. The sealed system keeps the room air separate from the combustion air. The convection blower's fan controller controls the fan's speed.

**3 START-UP TIMER.**

This 15 minute one shot timer, by-passes the 120° F (49°C) temperature sensor allowing the unit to operate when cold. The timing cycle is initiated by pressing the start-up switch. The 15 minute timer is located right under the timing control module on the right side pillar. The unit is also responsible for initiating the ignition cycle.

**4 TIMING CONTROL MODULE.**

The timing control module is mounted in the middle, on the right rear pillar of the unit. This module controls the switching power of the auger motor. The module's switching duty cycle is controlled by the Dial-A-Fire.

**5 AUGER MOTOR.**

This 1RPM motor is responsible for turning the auger, which in turn transports pellets to be dropped into the burn pot liner. The auger motor's control is handled by the timing control module and Dial-A-Fire.

**6 COMBUSTION/EXHAUST PHASE CONTROLLER (Blower speed control module).**

The phase controller supplies an adjustable voltage to the combustion blower. The voltage controls the blower's speed. The module is controlled by the potentiometer in the Dial-A-Fire. As the feed rate is increased, the blower's speed is increased proportionally.

**7 IGNITER.**

This is a heating element used to ignite the fuel. When the pellet stove is started, the igniter is energized. Air passes through the igniter tube over the igniter. The air becomes super heated, drying the pellet fuel and then igniting the pellets through convection. The igniter is located in the center of the firebox next the air inlet tube.

**8 DIAL-A-FIRE (Heat output knob).**

This unit is responsible for controlling the timing of the auger motor. When turned clockwise it will cause the OFF time between auger pulses to shorten. Resulting in more heat output and pellet consumption. Turn the knob counter-clockwise and the reverse will happen. When this knob is turned fully counter-clockwise past the click, the auger motor will be turned off. This component also controls the exhaust blower speed via the PHASE CONTROLLER.

**9 START-UP SWITCH.**

When the momentary contact switch is pressed it will initiate the 15 minute Start-Up Timer including the igniter.

**10 AUGER PULSE LIGHT.**

This light will flash in conjunction with the pulses to the auger.



11 **CONVECTION FAN CONTROLLER.**

This controller is responsible for varying the speed of the convection blower.

12 **200° F (93° C) MANUAL RESET TEMPERATURE SENSOR.**

This sensor (located on the right side hopper) has a red button located in the center of the sensor. This sensor will turn the auger OFF if the hopper reaches 200° F (93° C). Depress the button to reset if the sensor has been activated.

13 **120°F (49°C) N/O, TEMPERATURE SENSOR (SHUT-DOWN SENSOR).**

This sensor (mounted on the exhaust blower housing) has two functions:

Should the fire go out, this sensor will shut the stove off when the exhaust temperature drops below 120°F (49°C). When the auger is turned off via the dial-a-fire, the exhaust temperature will drop, when it goes below 120°F (49°C) the sensor will turn the stove off.

14 **120°F (49°C) N/C, TEMPERATURE SENSOR (IGNITER SHUT DOWN SENSOR).**

This sensor (mounted on the exhaust channel) will turn the igniter off when the firebox temperature reaches 120°F (49°C).

15 **EXHAUST/COMBUSTION BLOWER.**

This variable speed fan (mounted on the left side of the stove) is responsible for drawing the outside fresh air into the combustion chamber for burning. The hot air then continues to be drawn over the heat exchanger tubes and into the exhaust channel. It is then pushed out through the exhaust system. A motor speed controller tied in with the Dial-A-Fire controls the speed of the blower.

16 **VACUUM SWITCH.**

This safety device (mounted on the left side back pillar) detects vacuum in the exhaust system. If the exhaust blower fails or the vent pipe becomes plugged, this switch will sense that there is no airflow and will stop the auger from continuing to feed pellets.

17 **THERMOSTAT INTERFACE.**

This control module is responsible for switching between a factory setting (for auger timing and exhaust voltage) and the control panel settings when the wall thermostat calls for heat.

**Exhaust trim:** Used to increase or decrease voltage to exhaust blower.

**Auger trim:** Used to increase the fuel feed rate for poor or lesser quality fuels.

**Thermostat hook up:** Install a 12 or 24, volt thermostat in this location.

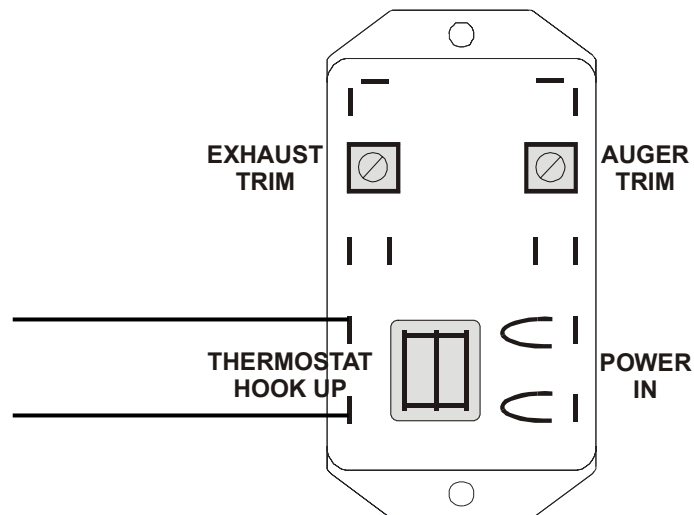

---

## TROUBLESHOOTING:

---

### DO NOT:

- Hold the start-up switch down, this is a momentary contact switch and can be damaged if held down too long.
- Service the stove with wet hands. The stove is an electrical appliance, which may pose a shock hazard if handled improperly. Only qualified technicians should deal with possible internal electrical failures.
- Remove any screws in the firebox without first lubricating them with penetrating oil.

### ***What to do if:***

1. The stove will not start.
2. The stove will not operate when hot.
3. The exhaust blower will not function normally.
4. The convection blower will not function normally.
5. Igniter : The pellets will not light.
6. The auger motor does not function normally.
7. The Dial-A-Fire has no effect on the fire.
8. The stove will not shut off.
9. The stove keeps going out.
10. Thermostat interface does not work correctly.

**\*NOTE:** *All troubleshooting procedures should be carried out by qualified technicians or installers.*

### **1. The stove will not start**

- Make sure the stove is plugged in and the wall outlet is supplying power.
- Push the Start-up switch, if the stove fails to start, unplug the unit and open the hinged side panels (held tight with one screw at the top, front).
- With the stove unplugged, examine all connections. Make sure they are firmly connected and that there are no exposed wires touching the stove (except the chassis ground wire).
- Check the continuity and placement of connections against the diagram in the back of this manual.
- Ensure that the connections to the (15) minute start-up timer are correct.
- Attempt to bypass the switch by inserting a jumper wire between the red and white wires that attach to the switch. Plug the stove back in. If the stove starts, replace the switch.
- If this fails, replace the (15) minute start-up timer.

## The stove will not operate when hot

- Unplug the stove, open the left side panel. Jump the two brown leads that are attached to the 120°F (49°C) Exhaust temperature sensor. If the stove operates replace the 120°F (49°C) sensor.

## 2. The exhaust motor will not function normally

- Open the left side panel, check all connections against the wiring diagram.
- Thoroughly check for broken wires or connections.
- If all the connections are verified and the exhaust blower does not function at all, tap lightly on the exhaust blower's motor end cap, this may loosen a tight motor.
- Apply 115 V directly to the exhaust blower. If the motor does not run, replace the blower.
- If the motor runs, check the exhaust potentiometer in the Dial A Fire. Remove the grey wires from the exhaust motor speed controller and measure the resistance (10 ohms. to 400k ohms). If this range is not present or it is an open circuit Replace the speed controller.
- Check all wires for continuity
- Replace the exhaust motor phase control (speed control module).

## 3. The convection blower will not function normally

- Check all the connections between the controller, switch, and the convection blower against the wiring diagram.
- If the convection motor will not run, apply 115 V to the motor directly. If the motor runs, replace the fan controller. If the motor does not run, the convection blower has failed. Replace the blower.
- If the convection blower runs on high at all times (no control with the fan controller), check the connections from the 160°F (71°C) sensor (located on the upper left side of the firewall) and convection fan controller to the blower. Disconnect one of the wires from the sensor, if control of the convection blower returns to the fan controller, replace the sensor.
- If the motor is still on high, re-connect the sensor and replace the convection fan controller.

## 5. Igniter- the pellets will not light

Everything else in the stove operates but the igniter will not light the pellets

- Make sure the burnpot liner is up tight and square to the ignitor tube.
- Check to see if the exhaust blower is operating.
- Check all the electrical connections on the 120°F (49°C) temperature sensor located on the exhaust channel.
- Check the connections at the igniter socket.
- Place a jumper wire between the two leads on the 120°F (49°C) temperature sensor. If the igniter works. **Replace the sensor.**
- If the igniter does not work. **Replace the igniter**

**NOTE:** The igniter should be bright orange in color. If not Replace the igniter.

## 6. The auger motor will not function normally

- Make sure the exhaust blower is operating.
- Make sure the dial-a-fire is turned on.
- Unplug the stove and open the side and back panels.
- Check all the connections to the auger motor, auger dial-a-fire, vacuum sensor, 200°F (93°C) temperature sensor and the timing control module against the wiring diagram in this manual.
- Check the condition of the vacuum hose (located on the left side of the stove). It should not be cracked or torn and should be installed on the top air inlet tube on the vacuum sensor.
- Check the manual reset button on the 200°F (93°C) temperature sensor. If this sensor has been tripped, check for the cause of the over-heating before pushing the red button in. Check auger for movement.
- If the auger still does not work, then apply 115 V directly to the auger motor. If the auger motor does not work, replace it.
- By-pass the 200°F (93°C) temperature sensor with a jumper wire to check the auger. If the auger works replace the sensor.
- Check the vacuum sensor by placing a jumper wire between the blue wires that are attached to the sensor. If the auger works, test to see if the exhaust blower is producing enough firebox vacuum.
- To test the exhaust vacuum place a magnehelic gauge in the sensor end of the vacuum tube. It should read 0.23" wc. If the reading is good then replace the vacuum sensor.
- If the auger motor still does not work, then attempt to by-pass the auger dial-a-fire control by removing the leads from the timing control module's second delay pins and placing a jumper across the pins. If the auger now cycles very quickly, test the dial-a-fire potentiometer. If the auger did not cycle then replace the timing control module.
- To test the dial-a-fire potentiometer. The potentiometer should have a range of 34K to approximately 900 K ( $\pm 10\%$ ), if the range is not close then replace the potentiometer. Check the voltage across the load pins of the timing module. It should be around 1-2 V, cycling to line voltage during an auger pulse. If not, replace the timing control module.

## 7. The dial-a-fire has no effect on the fire

- Make sure all connections to the timer control module are secure.
- Perform a resistance test to the dial-a-fire potentiometer, by placing the two test leads from a multimeter into the leads of the potentiometer. The potentiometer should have a range of 34K to approximately 900 K ( $\pm 10\%$ ).

### *Potentiometer Readings:*

Full counter-clockwise (switched off) = open circuit, overload or Infinite resistance

Low fire..... 800 K to 900 K

High fire                    34 K to 40 K

If the range is not close or does not vary then replace the potentiometer.

## 8. The stove will not shut down

- Check the connections to the 120°F (49°C) exhaust temperature sensor, start-up switch and the start-up timer against the wiring diagram.
- Check the 120°F (49°C) temperature sensor by removing one of the brown wires from the sensor. The unit should shut down right away as long as the start button was not pressed within 15 minutes of this test. If the stove shuts down within 15 minutes, replace the 120°F (49°C) sensor. If the stove does not shut down within 15 minutes, test the switch.
- To test the switch, the stove must be cold. Pull the plug, then plug the stove back in. If the fails to start, Replace the switch.

## 9. The stove keeps going out

- If the stove goes out and leaves fresh unburned pellets or cigarette-like ashes in the burn pot liner, the fire is going out before the 120°F (49°C) temperature sensor shuts the stove off.
  - Check to see that the slider is in the correct position.
  - Turn the Dial-a-Fire up slightly (poor quality pellets will require slightly higher settings).
- If the stove goes out and there are partially burned pellets left in the burn pot liner, the stove shuts down due to a lack of air, exhaust temperature or power failure.
  - Adjust the slider damper.
  - Check to see if the stove needs a more complete cleaning.
  - Turn the Dial-a-Fire up slightly (poor quality pellets will require slightly higher settings).
  - Did the power go out?
- If the stove goes out and there are no pellets in the liner, the auger is stopping.
  - See “The auger motor will not function normally” and “The exhaust blower will not function normally.”

## 10. Thermostat Interface does not work correctly

- Make sure that the thermostat is calling for heat
- Make sure that the Dial-A-Fire is set to the desired setting.
- Make sure of all electrical connections at the thermostat and the thermostat Interface.
- Remove the two thermostat wires from the thermostat Interface and place a jumper over the two thermostat interface pins, Control with Dial-A-Fire should be restored, If not replace the Thermostat Interface.
- If control comes back to the unit check, Continuity at the thermostat connections and Thermostat wires.
- Replace the thermostat.

# WIRING DIAGRAM

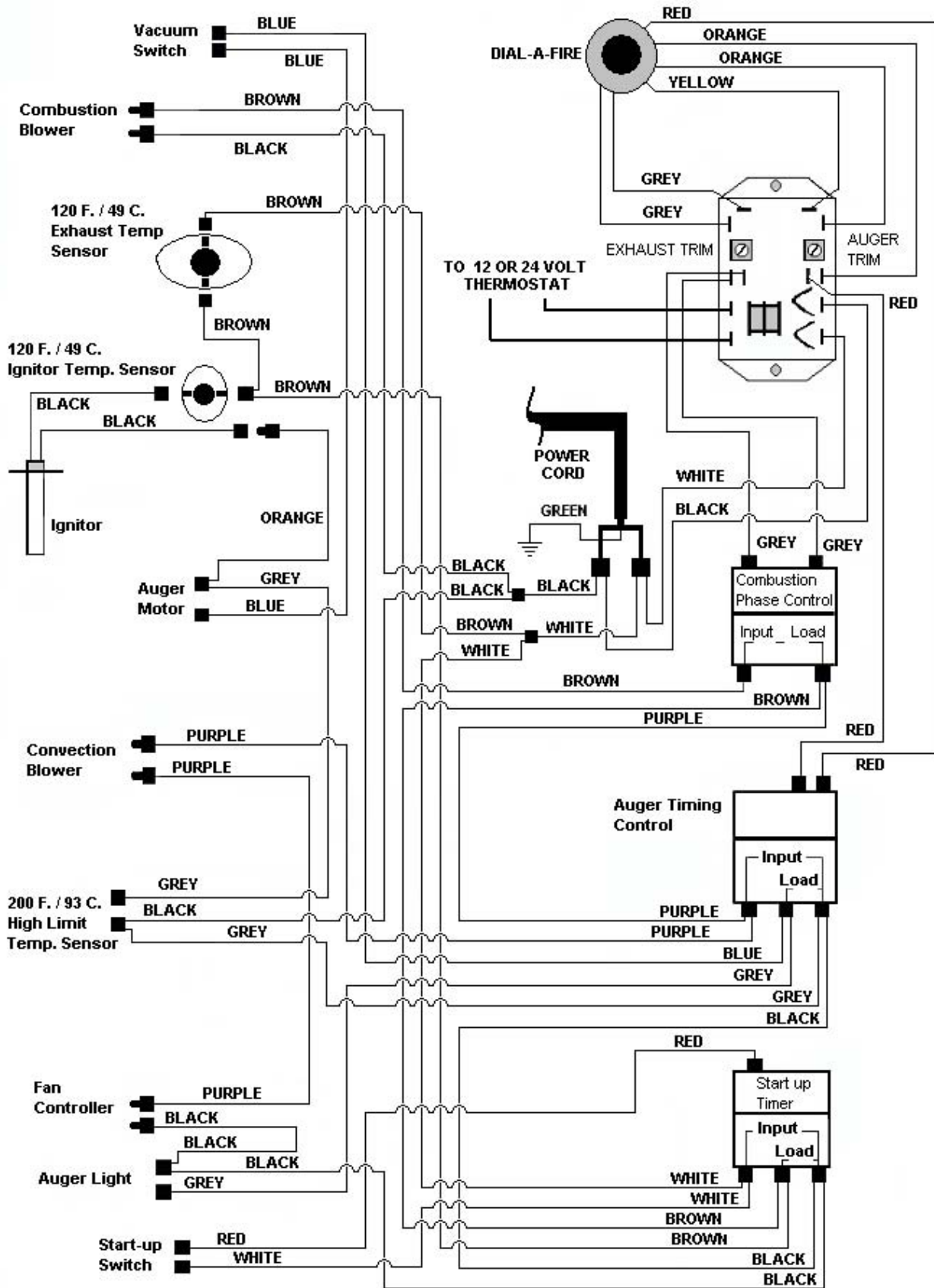

## PARTS LIST

EF-037	POWER UP TIMER	20-038	EF5 CAST TOP
EF-043	START-UP SWITCH	20-045	EF 5 FIREBOX BRICK LINER
EF5-101	S.S. SIDE PANELS (2) AND HOPPER LID	20-054	EF5 S.S. BURN POT LINER
EF5-103	EVOLUTION HEARTH PAD	20-073	EF 5 UPGRADE KIT
EF5-104	OUTSIDE COMBUSTION BLOWER HOUSING	20-074	EF 5 DIAL-A-FIRE
EF5-105	200 HIGH LIMIT TEMP SENSOR MR	20-094	EF5 TOP GLASS RETAINER
EF5-106	FAN CONTROLLER	50-084	EF5 THERMOSTAT INTERFACE ONLY
EF5-107	GREEN LIGHT	50-088	EF5 DOOR GASKET (60 INCHES)
EF5-109	120° F EXHAUST TEMP SENSOR	50-096	EF5 EXTERIOR EXHAUST ADAPTER
EF5-110	120° F IGNITION TEMP SENSOR	50-097	EF5 NICKEL LOUVER SET
EF5-112	AUGER TIMER CONTROL	50-162	EF5 ASH LIP LOUVER NICKEL
EF5-113	POWER UP TIMER		
EF5-114	COMBUSTION BLOWER		
EF5-115	VACUUM SWITCH		
EF5-116	AUGER MOTOR		
EF5-118	AUGER		
EF5-119	CONVECTION BLOWER		
EF5-120	CONVECTION BLOWER MOUNT		
EF5-121	CONTROL PANEL DOOR		
EF5-122	CONTROL PANEL		
EF5-123	CONTROL PANEL DECAL		
EF5-124	EF5 FIREBOX LINER		
EF5-128	BURN POT		
EF5-129	ASH PAN		
EF5-131	ASH PAN COVER		
EF5-134	DOOR HANDLE		
EF5-136	PAINTED DOOR ONLY		
EF5-137	SLIDER DAMPER PLATE		
EF5-138	HEAT EXCHANGER ROD		
EF5-139	BACK GRILL		
EF5-140	HOPPER LID PAINTED		
EF5-149	IEC POWER CORD		
20-018	EF5 LEVELING LEGS		
20-019	EF5 OWNERS MANUAL		
20-020	EF5 HARDENED BUSHING		
20-021	EF5 WIRING HARNESS		
20-022	EF5 IGNITER 120 V		
20-023	EF5 GLASS (356 X 356 MM )		
20-024	EF5 AUGER SHAFT		
20-025	EF5 LIGHTING INSTRUCTIONS		
20-026	EF5 THERMOSTAT CONTROLLER		
20-029	EF5 S.S. CAB SIDE LEFT		
20-030	EF5 S.S. CAB SIDE RIGHT		
20-031	EF5 PAINTED CAB SIDE LEFT		
20-032	EF5 PAINTED CAB SIDE RIGHT		

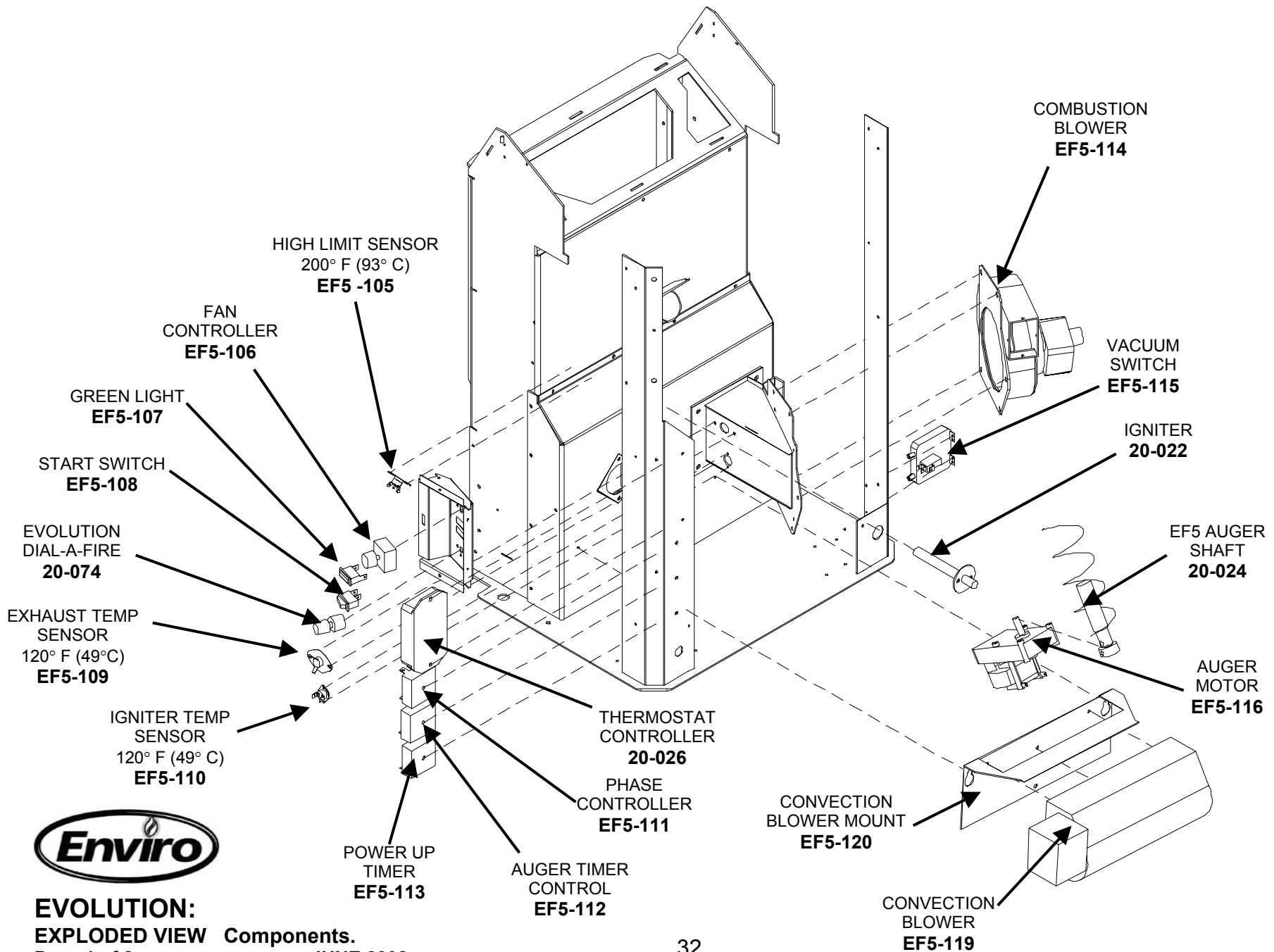



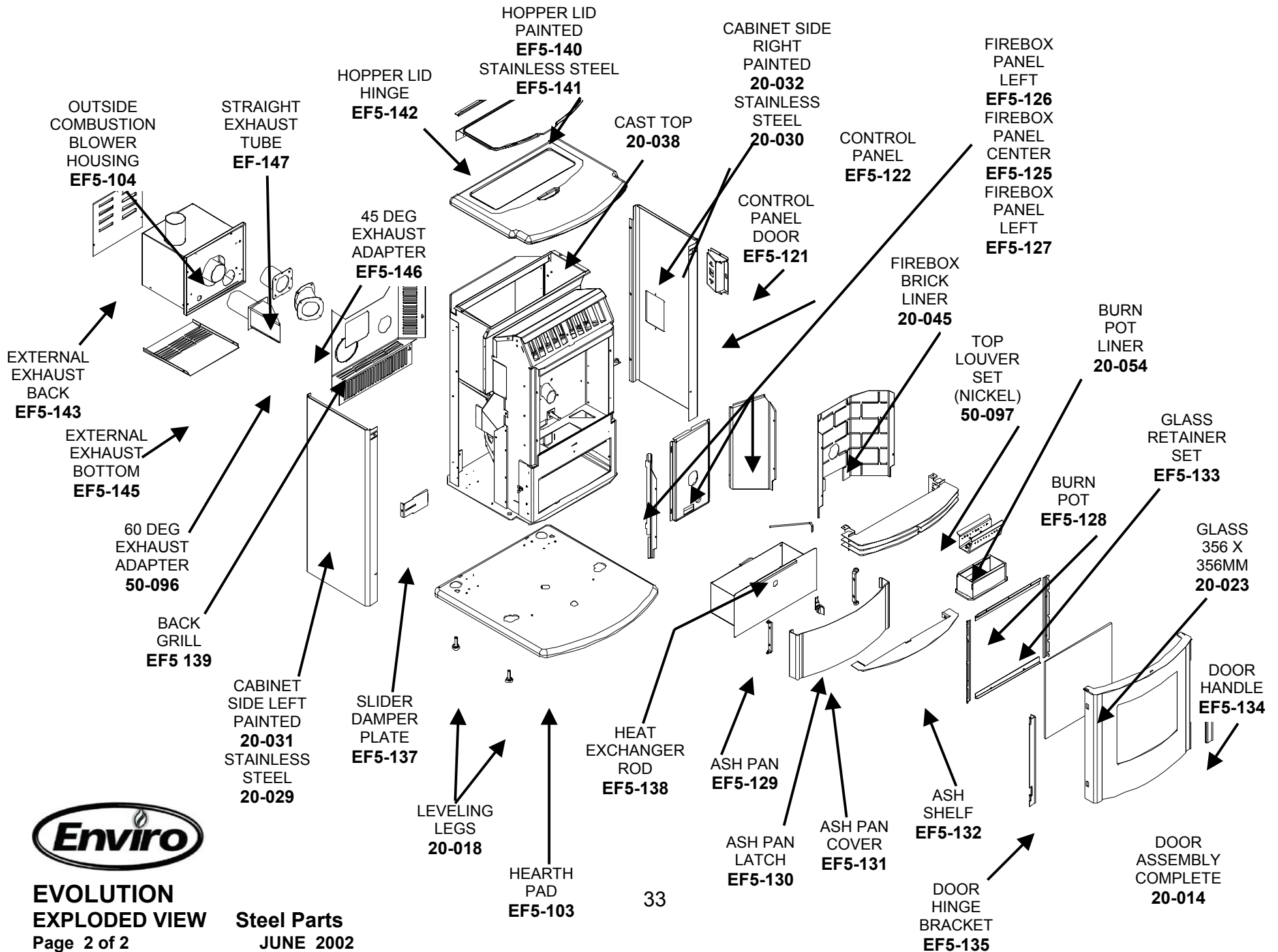

---

# WARRANTY

---

Sherwood Industries Ltd. gives a five year limited warranty on all steel manufactured parts. A one-year warranty is provided on all electrical components. The above limited warranties are extended only to the original purchaser.

There is no warranty on the following parts:

- fiberglass rope baskets
- refractory material
- burn pot liner
- paint
- enamel finish or gold plating where it applies, and,
- vacuum hose.

**\*\*NOTE:** The paint on the brick firebox lining may peel, this is due to the extreme conditions applied to the paint and is in no way covered under warranty.

## WHEN FILLING A WARRANTY CLAIM PLEASE COMPLETE THE FOLLOWING INFORMATION ON AN OFFICIAL WARRANTY CLAIM FORM:

### TO THE DEALER:

- Name, Address and Telephone Number of purchaser and date of purchase.
- Date of Installation. Name of the installer and dealer. Serial Number of the appliance. Nature of the complaint, defects or malfunction, description and part # of any parts replaced.

### TO THE DISTRIBUTOR:

- Sign and verify that work and information are correct.

### **ENSURE THAT YOU SPECIFY THE NATURE OF THE COMPLAINT, DEFECT, PERIODICAL MALFUNCTION, ETC.**

The limited warranty covers defects in materials and workmanship as long as the products has been installed according to the manual's instruction. If the product is damaged or broken as a result of mishandling or misuse, the warranty does not apply. Removal and re-installation costs are not covered under this warranty.

It is the manufacturer's option whether to repair or replace the appliance. The shipping cost to and from the factory is paid by the consumer. All warranties by the manufacturer are set forth herein and no claim shall be made against the manufacturer on any oral warranty or representation.

Sherwood Industries Ltd. assumes no responsibility for damage caused by household power fluctuations or power surges.

Under Warranty

### **For the do-it-yourself Individual**

The consumer should be aware that the pellet appliance needs setting using tools that he/she might not have. Consult an ENVIROFIRE dealer. It is recommended than only an authorized ENVIROFIRE dealer installs an ENVIROFIRE unit. There will be no warranty coverage on parts destroyed or burnt out as a result of a consumer installation error or defect.

Sherwood Industries Ltd. reserves the right to make changes without any notice.

4/5/2005

**E-MAIL ADDRESS ( [www.envirofire.biz](http://www.envirofire.biz) )**